



The City of Port St. Joe

Post Office Box 278 • Phone (850) 229-8261
Port St. Joe, Florida 32457

Sewer Availability Notification

February 15, 2011

Dear Property Owner;

The City of Port St. Joe has expanded its Sewer Service Area and is urging property owners to use the City of Port St. Sewer System. The system is available to the following areas:

1. All property located within the City of Port St. Joe, White City, Highland View and St. Joe Beach north to Sea Shores Drive.
2. Property adjoining Jones Homestead Rd. and West Rutherford St..
3. Property adjoining Hwy C-30 up to 5540 Hwy C-30.
4. All property joining Cape San Blas Rd. up to the Barrier Dunes/Sea Cliffs Subdivision.

Please see attached map outlining sewer availability.

The current fees for a residential connection to the Sewer System are as follows:

\$2,570 Residential Impact Fee. (Financing is available up to 36 mos.**)

\$400 Tap Fee

\$1,895 Grinder Pump (our cost)

\$4,865 Total payable to the City of Port St. Joe

** The customer is responsible for hiring a licensed plumber to complete installation work and is subject to any additional cost associated with extension of the main sewer line to the customer's property.

The City of Port St. Joe looks forward to serving your sewer utility needs. If you have questions, please contact us at your earliest convenience.

Sincerely,

Charlie Weston
City Manager

MEL MAGIDSON, JR.
Mayor/Commissioner

GREG JOHNSON
Commissioner, Group I

CHARLES STEPHENS
Commissioner, Group II

LORINDA GINGELL
Commissioner, Group III

REX BUZZETT
Commissioner, Group IV

CHARLES W. WESTON
City Manager

JIM ANDERSON
City Auditor and Clerk

"An Equal Opportunity Employer"

— PRESSURE SEWER SERVICE
 — GRAVITY SEWER SERVICE

U.S. HWY. 98

SCALE: 1"=2000'

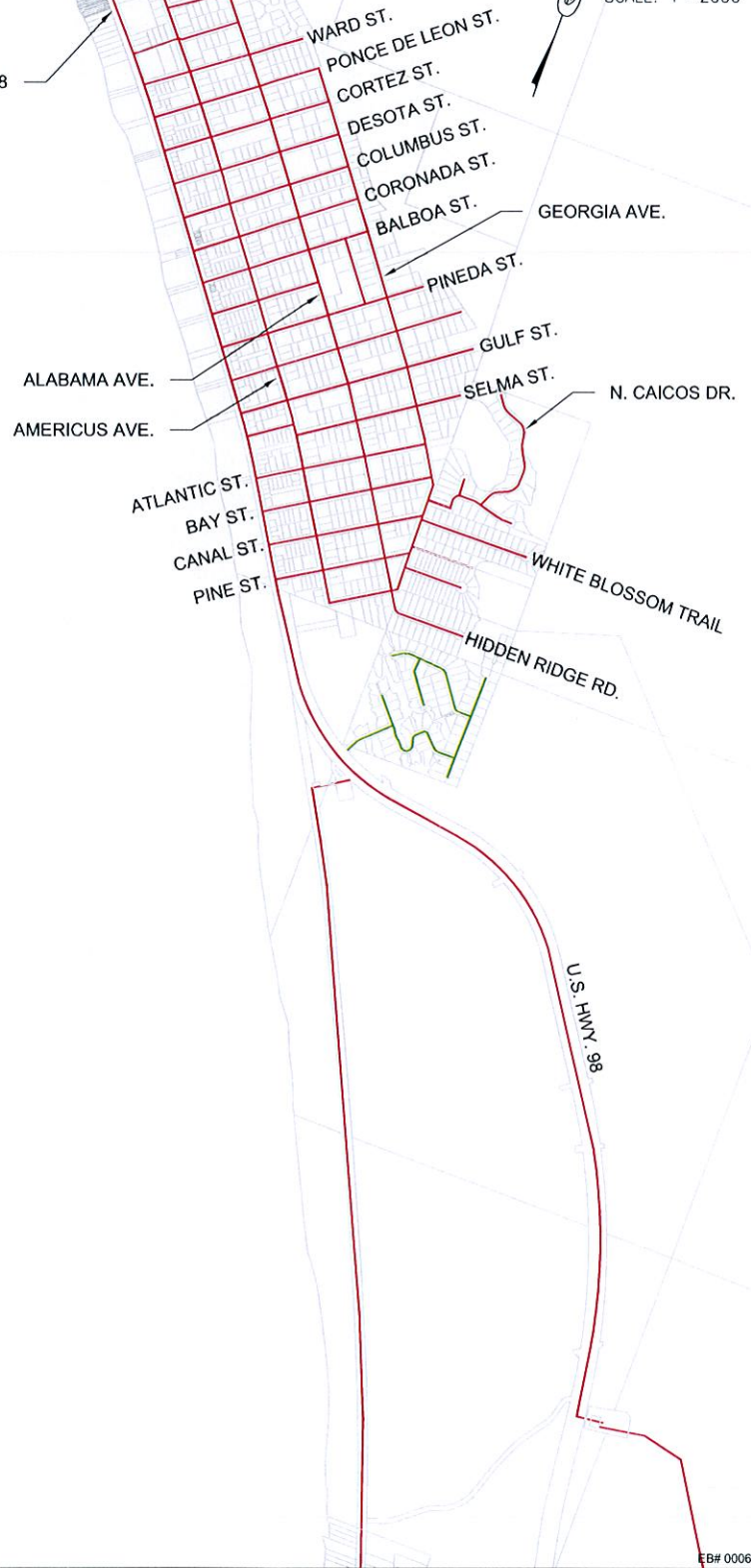

February 16, 2011 (17:24:58 EST)
 S:\019.000\DWG\SEWER SERVICE AREA MAP\019000-MAP.DWG

EB# 0006155

PREBLE-RISH INC
 CONSULTING ENGINEERS AND SURVEYORS
 CIVIL • SURVEYING • SITE PLANNING

324 MARINA DRIVE
 PORT ST. JOE, FL 32456
 (850) 227-7200

203 ABERDEEN PARKWAY
 PANAMA CITY, FL 32405
 (850) 522-0644

877 COUNTY ROAD 393
 SANTA ROSA BEACH, FL 32459
 (850) 231-3902

ST. JOE BEACH
 Sewer Service Area Map
 City of Port St. Joe
 Gulf County
 Florida

DATE: FEB 2011	PROJECT NO. 019.000
SCALE: AS SHOWN	SHEET 1
DRAWN: CAK	
CHECKED: SEP	

SCALE: 1"=2000'

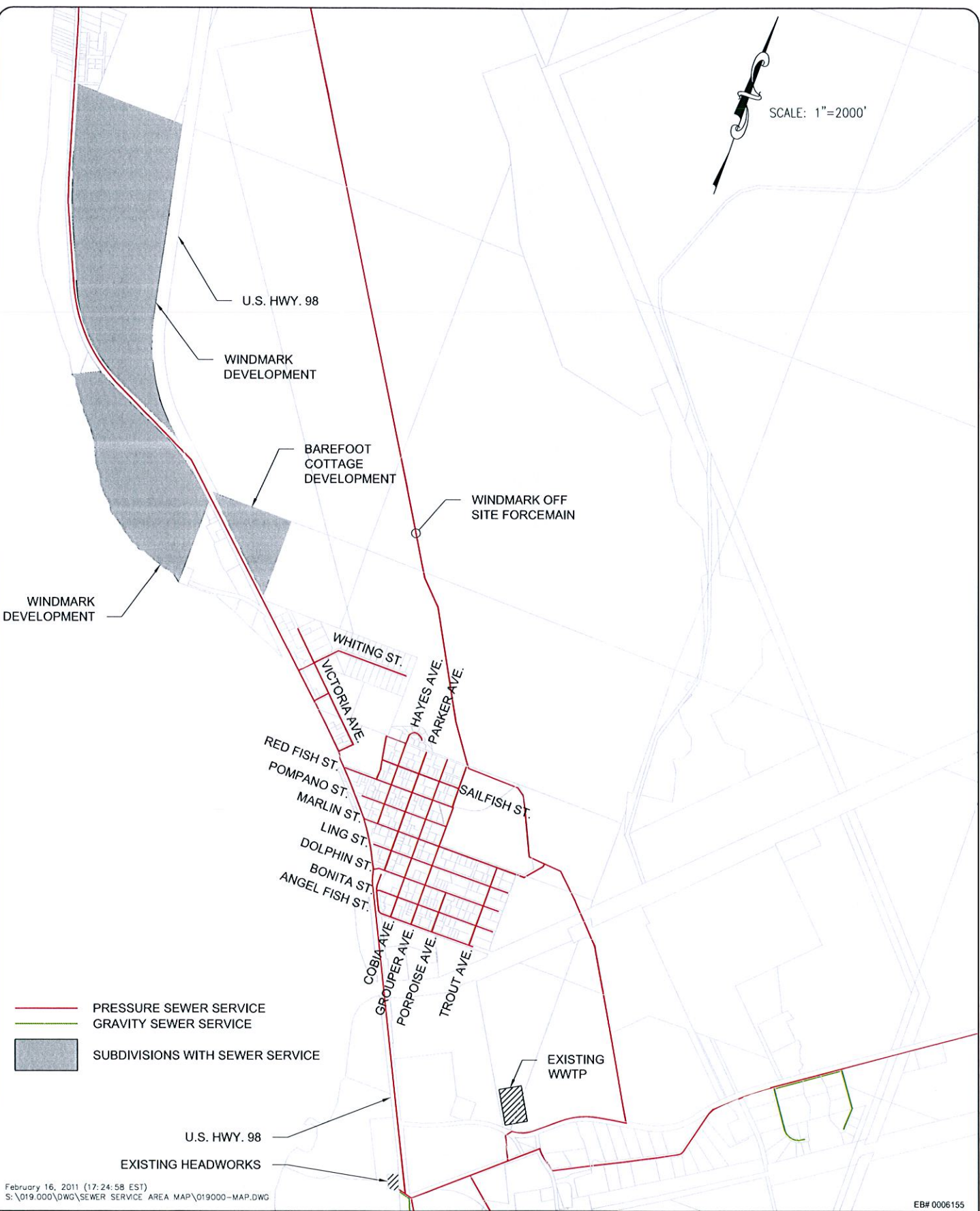

— PRESSURE SEWER SERVICE
— GRAVITY SEWER SERVICE
 SUBDIVISIONS WITH SEWER SERVICE

February 16, 2011 (17:24:58 EST)
 S:\019.000\DWG\SEWER SERVICE AREA MAP\019000-MAP.DWG

PREBLE-RISH INC
 CONSULTING ENGINEERS AND SURVEYORS
 CIVIL • SURVEYING • SITE PLANNING

324 MARINA DRIVE
 PORT ST. JOE, FL 32456
 (850) 227-7200

203 ABERDEEN PARKWAY
 PANAMA CITY, FL 32405
 (850) 522-0644

877 COUNTY ROAD 393
 SANTA ROSA BEACH, FL 32459
 (850) 231-3902

WINDMARK AND HIGHLAND VIEW

Sewer Service Area Map
 City of Port St. Joe
 Gulf County
 Florida

DATE: FEB 2011	PROJECT NO. 019.000
SCALE: AS SHOWN	SHEET 1
DRAWN: CAK	
CHECKED: SEP	

EB# 0006155

EXISTING HEADWORKS

U.S. HWY. 98

AVE. D
AVE. C
AVE. B
AVE. A

AVE. G

AVE. F
AVE. E

SCALE: 1"=2000'

U.S. HWY. 71

FIRST ST.

WESTCOTT CIRCLE

U.S. HWY. 71 / FIFTH ST.

TENTH ST.

CAPE SEWER FORCEMAIN

WOODWARD AVE.

SIXTEENTH ST.

BELLAMY CIRCLE

MONUMENT AVE.

TWENTIETH ST.

ALLEN MEMORIAL WAY
GAUTIER MEMORIAL LANE

LONG AVE.

GARRISON AVE.

MADISON ST.

U.S. HWY. 98

MONUMENT AVE.

— PRESSURE SEWER SERVICE
— GRAVITY SEWER SERVICE

February 16, 2011 (17:24:58 EST)
S:\019.000\DWG\SEWER SERVICE AREA MAP\019000-MAP.DWG

EB# 0006155

PREBLE-RISH INC
CONSULTING ENGINEERS AND SURVEYORS
CIVIL • SURVEYING • SITE PLANNING

324 MARINA DRIVE
PORT ST. JOE, FL 32456
(850) 227-7200

203 ABERDEEN PARKWAY
PANAMA CITY, FL 32405
(850) 522-0644

877 COUNTY ROAD 393
SANTA ROSA BEACH, FL 32459
(850) 231-3902

PORT ST. JOE
Sewer Service Area Map
City of Port St. Joe
Gulf County
Florida

DATE:
FEB 2011
SCALE:
AS SHOWN
DRAWN:
CAK
CHECKED:
SEP

PROJECT NO.
019.000
SHEET
1



SCALE: 1"=2000'

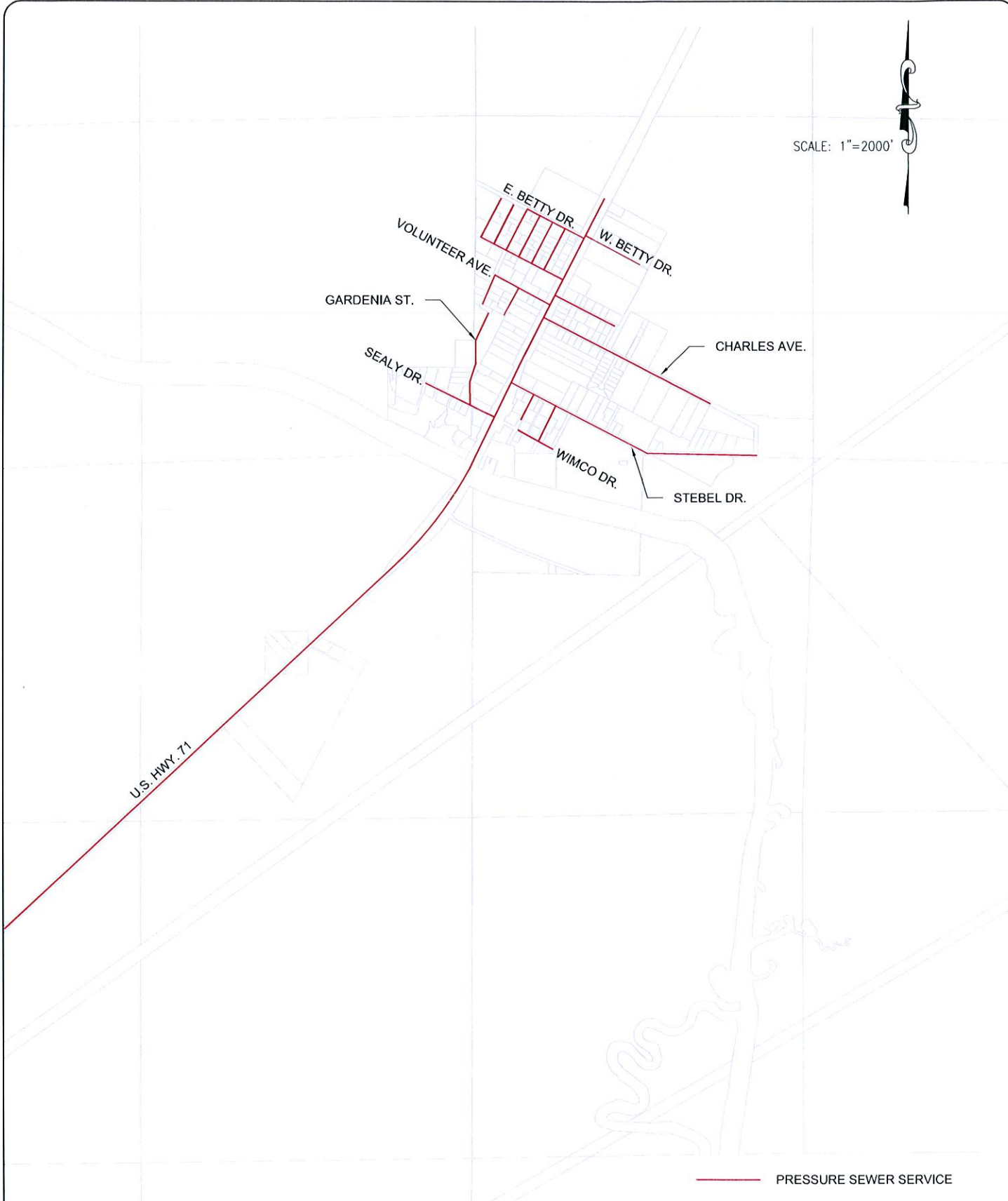

— PRESSURE SEWER SERVICE

February 16, 2011 (17:24:58 EST)
S:\019.000\DWG\SEWER SERVICE AREA MAP\019000-MAP.DWG

EB# 0006155

PREBLE-RISH INC
CONSULTING ENGINEERS AND SURVEYORS
CIVIL • SURVEYING • SITE PLANNING

324 MARINA DRIVE
PORT ST. JOE, FL 32456
(850) 227-7200

203 ABERDEEN PARKWAY
PANAMA CITY, FL 32405
(850) 522-0644

877 COUNTY ROAD 393
SANTA ROSA BEACH, FL 32459
(850) 231-3902

WHITE CITY
Sewer Service Area Map
City of Port St. Joe
Gulf County
Florida

DATE: FEB 2011	PROJECT NO. 019.000
SCALE: AS SHOWN	SHEET 1
DRAWN: CAK	
CHECKED: SEP	

SCALE: 1"=4000'





BARRIER DUNES

OVATION SUBDIVISION

SR30E (CAPE SAN BLAS ROAD)

VILL DEL SOL

JUBILATION

-  PRESSURE SEWER SERVICE
-  SUBDIVISIONS WITH SEWER SERVICE

February 16, 2011 (17:24:58 EST)
S:\019.000\DWG\SEWER SERVICE AREA MAP\019000-MAP.DWG

EB# 0006155

PREBLE-RISH INC
 CONSULTING ENGINEERS AND SURVEYORS
 CIVIL • SURVEYING • SITE PLANNING

324 MARINA DRIVE
PORT ST. JOE, FL 32456
(850) 227-7200

203 ABERDEEN PARKWAY
PANAMA CITY, FL 32405
(850) 522-0644

877 COUNTY ROAD 393
SANTA ROSA BEACH, FL 32459
(850) 231-3902

CAPE SAN BLAS

Sewer Service Area Map
City of Port St. Joe
Gulf County
Florida

DATE:
FEB 2011

SCALE:
AS SHOWN

DRAWN:
CAK

CHECKED:
SEP

PROJECT NO.

019.000

SHEET

1

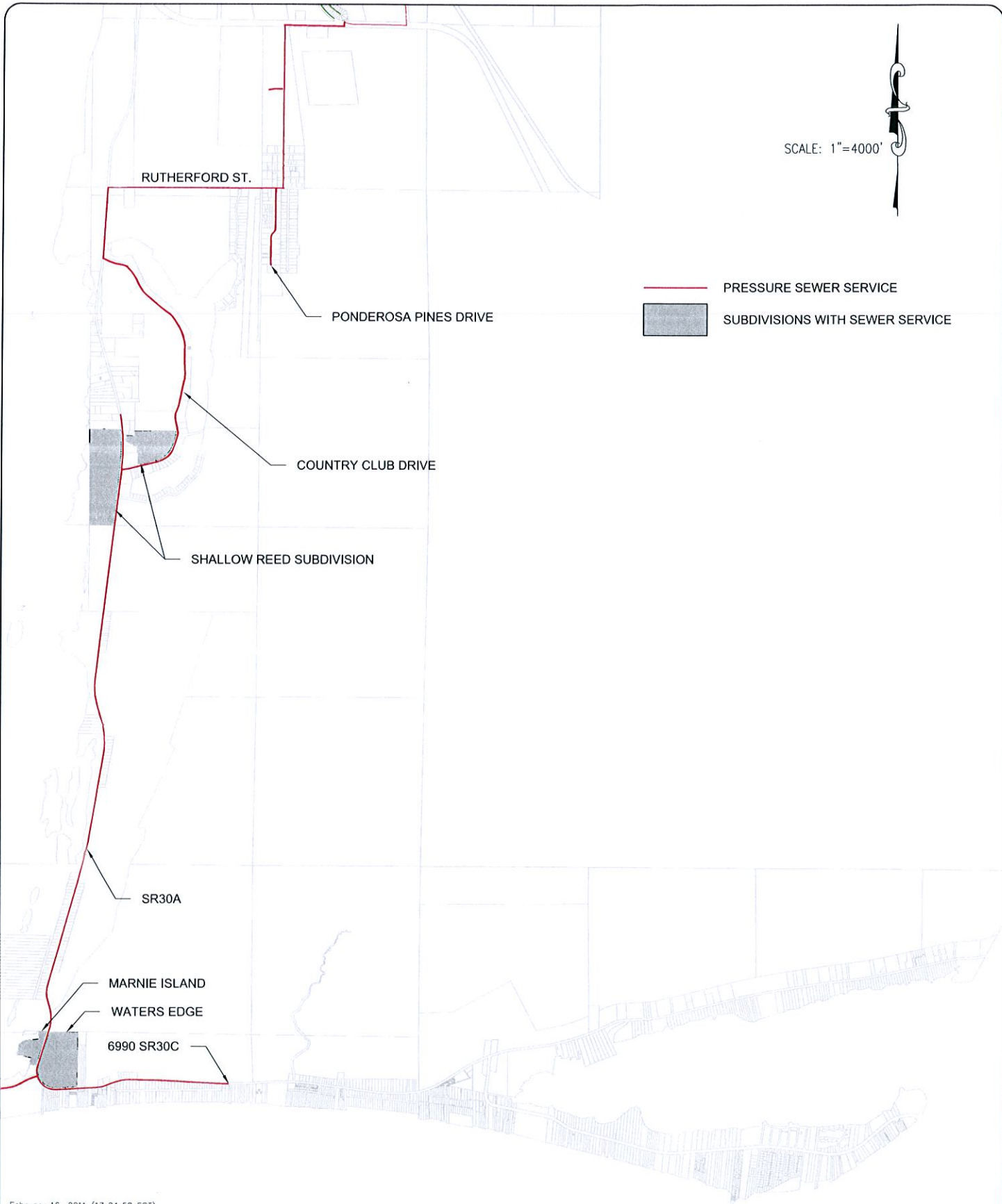

February 16, 2011 (17:24:58 EST)
 S:\019.000\DWG\SEWER SERVICE AREA MAP\019000-MAP.DWG

EB# 0006155

PREBLE-RISH INC
 CONSULTING ENGINEERS AND SURVEYORS
 CIVIL • SURVEYING • SITE PLANNING

324 MARINA DRIVE
 PORT ST. JOE, FL 32456
 (850) 227-7200

203 ABERDEEN PARKWAY
 PANAMA CITY, FL 32405
 (850) 522-0644

877 COUNTY ROAD 393
 SANTA ROSA BEACH, FL 32459
 (850) 231-3902

CAPE SAN BLAS AND INDIAN PASS

Sewer Service Area Map
 City of Port St. Joe
 Gulf County
 Florida

DATE: FEB 2011	PROJECT NO. 019.000
SCALE: AS SHOWN	SHEET 1
DRAWN: CAK	
CHECKED: SEP	