

November 20, 2012

**Workshop Meeting
Water Distribution Profile & Pilot Study
5:00 p.m.**

**Regular Public Meeting
6:00 p.m.**

**Commission Chamber
City Hall
Port St. Joe, Florida**



City of Port St. Joe

Mel Magidson, Mayor-Commissioner
Bill Kennedy, Commissioner, Group I
Bo Patterson, Commissioner, Group II
Phil McCroan, Commissioner, Group III
Rex Buzzett, Commissioner, Group IV

[All persons are invited to attend these meetings. Any person who decides to appeal any decision made by the Commission with respect to any matter considered at said meeting will need a record of the proceedings, and for such purpose may need to ensure that a verbatim record of the proceedings is made, which record includes the testimony and evidence upon which the appeal is to be based. The Board of City Commission of the City of Port St. Joe, Florida will not provide a verbatim record of this meeting.]

BOARD OF CITY COMMISSION

Regular Public Meeting

6:00 p.m.

City Hall

Commission Chamber

Tuesday November 20, 2012

Call to Order

Consent Agenda

Minutes

- Workshop Meeting 10/16/12 Page 1
- Regular Meeting 10/16/12 Pages 2-7
- Special Meeting 10/25/12 Page 8-10

City Attorney

- Ord. 488 Service Fees Pages 11-12
 - 1st Reading
- Ord. 489 Capital Improvement Plan Update Pages 13-48
 - 1st Reading

Old Business:

- Lighthouse- Update
- RESTORE Act Committee- Update
- Centennial Celebration- Update
- RFP 2012-11 Chipola Pump Motor- Update
- CDBG Grant, Water Distribution- Update
- WastePro Rates- Discussion
- Soccer Complex- Discussion

New Business:

- Billy Dixon- Citizen Concerns Pages 49-53
- Eastern Shipbuilding Group Utility Easement
- Water Distribution Profile & Pilot Study
- Garden Club- Request for Reduction in Rental Fees Page 54
- DOT Request- Comm. Patterson
- City Computer System
- Mattox House- Lease Agreement Page 55-57
- Fire Dept. Surplus Page 58
- EDC and Chamber Funding

Public Works

- Work Truck- Request to purchase Page 59
- RFP 2012-12, First St. lift Station Award (Handout)

Surface Water Plant

- Update

Waste Water Plant

- Forklift- Request to Bid

City Engineer

- Headworks and Sprayfield
 - Change Order # 5
- Water Distribution Phase I- Update

Pages 60-61

Code Enforcement

- Update

Pages 62-63

Police Department

- Update

PSJRA

- Update

City Clerk

- Update

Citizens to be Heard

Discussion Items by Commissioners

Motion to Adjourn

MINUTES OF THE WORKSHOP FOR ISSUES REGARDING THE WATER DISTRIBUTION SYSTEM PHASE I REPLACEMENT MEETING OF THE BOARD OF CITY COMMISSIONERS FOR THE CITY OF PORT ST. JOE FLORIDA, HELD IN THE COMMISSION CHAMBER AT CITY HALL, OCTOBER 16, 2012, AT 5:30 P.M.

The following were present: Mayor Magidson, Commissioners Buzzett, McCroan, Patterson and Kennedy. City Manager Jim Anderson and City Clerk Charlotte Pierce were also present. Attorney Tom Gibson was absent.

The purpose of the meeting was to discuss issues regarding the Water Distribution System Phase I Replacement.

Mr. Anderson introduced Lee Hathaway of IC Contractors and then provided a history of the project. This a one year contract of approximately 8 miles of pipe. To date, roughly five miles of pipe has been put in the ground which is close to 60% of the project. C. W. Roberts Contracting has completed 11 paving patches and has 14 to go. Clean up work has been done on Sixth, Seventh and Eighth Streets over the weekend and there is still a good bit of work to be done. Highway 71, Woodward, Garrison, and Monument Avenues; Bird Alley; Westcott, Hunter and Bellamy Circles; as well as First, Third and Fourth Streets have been completed. Currently work is being done on Sixth, Seventh and Eighth Streets with work remaining to be done on Ninth Street and Woodward and McClellan Avenues between Tenth and Sixteenth Streets. North Port St. Joe was pulled from the project and an application has been submitted for a CDBG Grant.

Commissioner Buzzett asked if Mr. Hathaway was comfortable with Preble Rish time line for the project.

Mr. Hathaway responded that per the contract, there were no time lines associated with the paving. Plans had been made to have paving repairs made several times during the project but when the rain began in July repairs were delayed. Mobilization is very pricey and temporary asphalt patches have been made. C. W. Roberts Contracting will be making the final patches soon.

Commissioner Buzzett asked Mr. Hathaway how he felt about boring versus cutting. Mr. Hathaway prefers boring, there is less disruption, but it will be necessary to value the tearing out an intersection and anticipate maintenance repairs when boring is involved.

John Grantland noted that there had been several hits on the gravity sewer lines, issues with the sub contractors and some unknowns.

Commissioner Kennedy expressed his disappointment in how the right of ways and driveways are being left on the weekends. He asked that the contractors be more conscientious.

Commissioner Patterson asked that residents be notified when work would be done on the weekends.

Mayor Magidson adjourned the Workshop at 5:48 P.M.

Approved this _____ day of _____ 2012.

Mel C. Magidson, Jr., Mayor

Charlotte M. Pierce, City Clerk

MINUTES OF THE REGULAR MEETING OF THE BOARD OF CITY COMMISSIONERS FOR THE CITY OF PORT ST. JOE, FLORIDA, HELD IN THE COMMISSION CHAMBER AT CITY HALL, October 16 2012, AT 6:00 P.M.

The following were present: Mayor Magidson, Commissioners Buzzett, McCroan, Patterson and Kennedy. City Manager Jim Anderson and City Clerk Charlotte Pierce were also present. City Attorney Tom Gibson was absent.

CONSENT AGENDA

Minutes

A Motion was made by Commissioner Buzzett, second by Commissioner Kennedy, to approve the Minutes of the Special Meeting of September 28, 2012; Joint City / County Workshop of October 1, 2012, and the Regular Meeting of October 2, 2012. All in Favor; Motion carried 5-0.

CITY ATTORNEY - Tom Gibson

There was no update as Mr. Gibson was unable to attend the meeting.

CITY MANAGER'S REPORT

Old Business

Lighthouse

Charlotte Pierce shared that the St. Joseph Historical Society, Inc., had vacated the Cape San Blas Lighthouse complex as of Friday, October 12, 2012. Contents of the Sleeping Beauty Gift Shop have been relocated to the Maddox House which was made available to the Society by the Commission and with the approval of the Florida Communities Trust. Mrs. Pierce participated in a phone conference with Eglin officials earlier today and work has begun to build a new road into the lighthouse complex. It is anticipated that the process of relocating the two keepers' quarters and oil shed inland for protection will be completed by mid December.

RESTORE Act Committee

Mr. Anderson attended the meeting but there was not a quorum. Presenters proceeded with their presentations for those in attendance.

Commissioner Kennedy asked that another representative be selected to represent the City as his schedule will not permit him to attend for the next few months. A Motion was made by Commissioner Buzzett, second by Commissioner Patterson, for Mr. Anderson to serve as the City's representative. All in Favor; Motion carried 5-0.

Centennial Celebration

The Committee will be meeting Thursday, October 18, 2012, to continue formulating plans for the celebration. Mayor Magidson encouraged anyone with ideas for the celebration to contact City Hall.

RFP 2012-11 Chipola Pump Motor

Commissioner Buzzett advised that he received a call from Jonathan Steverson, Executive Director of the Northwest Florida Water Management District, today and NFWFMD would fund the balance due for the motor.

Amendment 4

Mr. Anderson shared that the Florida League of Cities opposes Amendment 4. Mayor Magidson suggested that citizens refer to the James Madison Institute website as they are an excellent source of information. The institute breaks down the amendment language and puts it in plain English so you can understand what it means, gives you the pros and cons of the amendment, who supports it

as well as who is opposed to it and makes a recommendation on the amendment. He also encouraged everyone to "Educate yourself on all the amendments."

Service Fees

Ordinance 311 addresses the charges for Service Fees. A proposal to change the rates will be presented at the next Commission meeting.

Ghost on the Coast will be held on Wednesday, October 31, 2012, beginning at 6:00 P.M. Donations of candy are being received by the merchants to help with the event. Dana Boyer has requested, and it was granted by consensus, that the fire whistle be sounded to let merchants know when it is time to begin passing out candy. City employees will be contributing candy to be disbursed from the City booth.

Barry Sellers, Executive Director of the Gulf County Chamber of Commerce stated that the Chamber supports the Ghost on the Coast festivities.

New Business

Eastern Shipbuilding Group Impact Fees

A request has been received from Eastern Shipbuilding Group to waive any utility facility charges. A letter was provided by Attorney Gibson that stated, "We have addressed this issue in the past and the Commission determined that when an applicant for services actually demolished users of more water and sewer capacity than the applicant would use, we could waive the facility charges. I believe that the Commission would be justified, in this instance, in waiving those charges based on the prior use of the property. It would be my recommendation that the City charge the actual cost of the necessary meters plus the installation."

Mayor Magidson noted that the St. Joe Company prepaid for a large number of taps when WindMark was started and this was a large sum of money. Incentives have been offered in the past for companies to locate here and this request should be given serious consideration as the City wants to add Eastern as a customer and we will be selling them water.

Commissioner McCroan asked if the church was made to pay impact fees and stated he wanted all applicants to be treated fairly. Mr. Anderson responded that First Baptist Church did pay impact fees of approximately \$35,000 for water and sewer taps on the Family Life Center.

Commissioner Kennedy stated Oak Grove Church paid as well and that he had paid the fees across the street.

Commissioner Buzzett reminded the Board that this was job creation and revenue for the City and encouraged everyone to give the request consideration. He noted that the Board did not waive it for those groups but there is a difference and felt that the Board should look long and hard at this. "There is not a lot of information here from Eastern, do they want just Impact Fees only or Impact Fees as well as making the installations to get the meters up and running? It is not exactly clear what they want the City to do" he stated.

Barry Sellers, Executive Director of the Gulf County Chamber of Commerce, shared that City / County incentives normally given when a business locates in our community have not been granted. He would like to work with Mr. Gibson and Mr. Anderson to see what can be done to help Eastern Shipbuilding.

Mack Woods of Eastern Shipbuilding noted that the 10" line is already in place. They would hook the meter to it, then their sub would come in and install any lines they need. Eastern will basically turn the water on and start paying the water bill.

John Grantland noted that all existing utilities are intact. He has worked with the engineers to formulate plans to run their extension and there will not be any real work for the City to do.

Commissioner Kennedy reiterated that he wanted jobs as much as anyone but he also wants the Board to be fair to all parties and be consistent. He would like to see a policy established for Impact Fees.

Mayor Magidson noted that companies have been offered incentives to locate in Port St. Joe. He feels that we can couch a reduction in fees based on the creation of the number of jobs and agrees with Commissioner Kennedy that it needs to be consistent and fair. Performance standards could be created, that if the entity produces a certain number of jobs the money would be escrowed and upon production of those jobs, a portion of the money could be returned to them.

Mr. Sellers advised that County / City incentives need to be established. The EDC is establishing a Business Plan and these issues should be established on the front end rather than the back and avoid the issues we are dealing with today.

Mr. Anderson shared that the statutes do allow for incentives, the City has the framework in place for the property taxes but he is not sure impact fees give this type leeway.

Enterprise FL has established criteria where the incentive is determined by how many jobs are created, the average wage and the investment buy the company.

Commissioner Patterson shared that all he has heard is how much we need jobs and did not see what would be accomplished by putting this off.

Mayor Magidson reiterated that the Commission was elected to serve the people of this community and we have to be careful that we are representing the people in what we do. Whether cutting Eastern Shipbuilding a break to bring in jobs, doing something otherwise that still allows for those jobs but treats the citizens fairly and basically takes \$60,000 out of their pockets, has to be decided.

Mr. Anderson reminded the Commission to look at the overall picture of the Debt Level Service. A huge chunk of money has been spent running water and sewer lines throughout the County. Impact Fees are for improvements to your city for the expansion of the water and sewer lines. If the City would have been collecting Impact Fees thirty years ago, the Debt Service would not likely be what it is today. Impact Fees were created in 2007 for improvements to the water and sewer systems.

Mayor Magidson noted that there are strong points on both sides for this and we want to welcome Eastern Shipbuilding but that we have to do this in a way that would be fair to our citizens and people that paid for this in the past.

Commissioner Patterson did not see what waiting two weeks would accomplish other than holding Eastern up.

Commissioner Kennedy stated that waiting would made the Commissioners be more responsible Board Members, allow time to set guidelines, stressed that no one is trying to block Eastern Shipbuilding, and this would be fair to everyone.

Commissioner McCroan shared that a structure needs to be in place and possibly escrow the money.

Commissioner Buzzett requested that a Special Meeting be held within the next two weeks to resolve this issue.

November 6, 2012 Commission Meeting / Election Day

The next Regular Commission Meeting is scheduled for November 6, 2012, which is the General Election. A Motion was made by Commissioner Buzzett, second by Commissioner Kennedy, to cancel the Meeting. All in Favor; Motion carried 5-0.

Water Distribution Phase II

A letter has been received from the Florida Department of Environmental Protection notifying the City that Amendment 2 to our State Revolving Fund Loan Agreement has been approved in the amount of \$1,845,438. A Motion was made by Commissioner McCroan, second by Commissioner Patterson, to execute the documents as requested. The project will not be bid at this time and engineering fees have been paid. All in Favor; Motion carried 5-0.

FDEP Status Reports

The Commission acknowledged receipt of the Florida Department of Environmental Protection Stewardship Inspection Site Visits for the Port St. Joe Waterfront Park and Shipyard Cove / Maddox Park.

Incubator Building

Mr. Anderson shared that he has talked Kim Bodine of the Gulf Coast WorkForce Board concerning a tenant for the Incubator Building.

IC Contractors – Water Distribution Phase I

Commissioner Buzzett continues to have issues with the paving process on roads that have been cut for the water line replacements. He felt that the Workshop today was good. It was noted that C. W. Roberts Contracting Inc., will be here Thursday to resume the road repairs. Commissioner Buzzett also requested that this item be kept on the agenda so that if the issue isn't resolved, it can be readdressed.

Public Works – John Grantland

Mr. Grantland shared that he is working with Willie Payne of Preble-Rish on the specs for the First Street Lift Station.

Surface Water Plant – Larry McClamma

Mr. McClamma reported that work will be finished on the Membrane Tank Friday. Painting will begin on Clarifiers 3 and 4 shortly. Kenny Wood has been working on a Maintenance Plan update, training sessions are continuing, metering pumps have been rebuilt, vertical pumps are being repacked, weekly maintenance walk through inspections are being implemented, a quarterly lubrication schedule is being developed, a rotating schedule for pumps and equipment in being established, operating procedures are being tweaked, a more systematic record of hours run are being logged and a lot of good, positive things are going on. Some design issues remain that need to be addressed.

Mr. Anderson shared that there will be a workshop next Tuesday with CDM and Northwest Florida Water Management District

Wastewater Plant – Lynn Todd

Ms. Todd noted that the #1 Grit King is down again and out of service. A representative is coming to assess the situation and solve the problem.

The John Deer Side Hill Mower has broken again and Ms. Todd asked that funds from the sale of scrap metals be used to upgrade the mower. The current tractor is not large enough to handle all that is required of it. The suggested remedy to the problem is to upgrade to a larger tractor that will also pull a bat wing mower.

Lead and Copper results are in and they were good.

City Engineer – Clay Smallwood

Mr. Smallwood advised the Board that there are planned water outages for Marvin Avenue and Tenth Street. Notification will be given to residents. Work continues on Seventh and Ninth Streets, as well as Woodward and McClellan Avenues South of Tenth Street.

Phase II Drawings – We are waiting to hear if the CDBG Application for the North Port St. Joe Water Systems Improvements is approved as funding will determine the final drawings. Road cuts vs. directional bores are being considered for the project.

Commissioner McCroan asked Mr. Smallwood if he was aware that the cement is falling off the walls of the chlorine contact chamber where the pipe comes through the influent side. Mr. Smallwood was not aware of the issue but would check on it.

Code Enforcement

Mr. Burkett's Activity Report was reviewed.

Mr. Anderson noted that Mr. Burkett has contacted local representatives of the St. Joe Company concerning the unsightliness of the old mill site and their response was that they had no interest in cutting the underbrush because of rebar and other materials left on the ground. Mayor Magidson will contact Jorge Gonzales concerning this.

Police Department – Chief Barnes

A Motion was made by Commissioner Kennedy, second by Commissioner Patterson, to purchase a 2012 Ford F150 Pick Up Truck from Cook-Whitehead Ford in the amount of \$35,650.25 as the K-9 Vehicle. All in Favor; Motion carried 5-0.

Mr. Anderson made the Commission aware of the process used for this purchase. Three used police vehicles were traded in on the truck and funds in the amount of \$13,650 from a FDLE Edward Byrne Memorial Justice Assistance Grant were also used. This did not go through the bid process because of the vehicles being traded in. Legal is okay with the process used and all local dealers were contacted.

PSJRA – Gail Alsobrook

Ms. Alsobrook shared that Coastal Design Landscape was awarded the landscaping / maintenance bid for Reid and Williams Avenues and the Dr. Joe Hendrix Parking Lot.

There is \$16,937.65 remaining in the Billy Joe Rish Parking Lot Grant. If the City wishes to utilize the remaining funds, a proposed list of improvements within the original scope of work needs to be submitted to USDA. Ms. Alsobrook has requested that they be allowed to use the funds for signage. Otherwise, the City needs to provide a letter requesting the deobligation of the remaining grant funds.

City Clerk – Charlotte Pierce

Mrs. Pierce noted that Humana Dental Insurance Cards have been mailed and asked that anyone who has not received their card contact her.

Citizens to be Heard

No one from the public wished to speak.

Discussion Items by Commissioners

Commissioner Buzzett shared his concerns about computer problems that have occurred at City Hall this week and that the problems are not being resolved in a timely manner.

Commissioner McCroan did not have anything to discuss at this time.

Commissioner Patterson noted that the Muhly Grass on Highway 71 (Cecil G. Costin, Sr., Blvd.) is obstructing views at the intersections and asked that the grass be kept cut. Properties that he had previously mentioned are being cleaned up and he encouraged citizens to take pride in their property and keep it clean.

Commissioner Kennedy encouraged everyone to participate in the Day of Declaration Fish Fry to be held Friday at Frank Pate Park. Proceeds will go to help fund the Day of Declaration scheduled for December 1, 2012.

Mayor Magidson did not have anything to discuss.

A Motion was made by Commissioner Buzzett, second by Commissioner McCroan, to adjourn the Meeting at 7:21 P.M.

Approved this _____ day of _____ 2012.

Mel C. Magidson, Jr., Mayor

Charlotte M. Pierce, City Clerk

**MINUTES OF THE SPECIAL MEETING OF THE BOARD OF CITY
COMMISSIONERS FOR THE CITY OF PORT ST. JOE, FLORIDA, HELD IN
THE COMMISSION CHAMBER AT CITY HALL, October 25, 2012, at 11:00 A.M.**

The following were present: Mayor Magidson, Commissioners Buzzett, McCroan, Patterson and Kennedy. City Manager Jim Anderson, City Attorney Tom Gibson and City Clerk Charlotte Pierce, were also present.

The purpose of the Special Meeting was the Eastern Shipbuilding Group Impact Fee Waiver Request; ADA Compliance Change Order #3 and IC Contractors Water Distribution System Phase I Replacement.

Eastern Shipbuilding Group Impact Fee Waiver Request

Mayor Magidson shared that Attorney Gibson had provided a letter based on past precedence when granting a waiver and shared that the Oak Grove Church was granted a waiver of Impact Fees in 2008 because of existing meters and houses being disconnected. First Baptist Church was not granted a waiver because the facility would be all new construction and there were no existing meters.

Commissioner McCroan noted that everyone who had spoken to him favored granting the waiver.

Commissioner Kennedy stated that he was incorrect previously about the Oak Grove Waiver Request and appreciated the research that had been done to clarify the information. He also shared that no one who spoke to him about the wavier for Eastern Shipbuilding objected to it being granted.

Mr. Anderson noted that there is approximately \$2,500 in meter cost to the City and Eastern should agree to pay any out of pocket cost of the City.

A Motion was made by Commissioner Patterson, seconded by Commissioner Buzzett, to grant the Impact Fee Waiver Request to Eastern Shipbuilding. All in Favor; Motion carried 5-0.

ADA Compliance Change Order #3

Mr. Anderson shared that the City has been approved for additional design services to the ADA Project which will include replacing floor tile in the Fire Station bathroom, complete removal of accessibility barriers in a manner that provides acceptable uniform aesthetic quality and replaces worn out infrastructure, in both the Men's and Women's Restrooms at the Centennial Building, replace finishes and defective plumbing and plumbing fixtures. This will basically give the restrooms a makeover and bring them into ADA Compliance.

A Motion was made by Commissioner Patterson, second by Commissioner Kennedy, to approve ADA Compliance Change Order #3 in the amount of \$69,475.26 plus \$2,125 for Architectural Fees. The full amount is covered by grant funds. All in Favor; Motion carried 5-0.

IC Contractors Water Distribution System Phase I Replacement

Paving issues were discussed and it was noted that we have value engineered the paving cost. Even though it has been inconvenient, progress is being made and staying within budget has been accomplished.

Mr. Anderson noted the following:

Waste Pro is providing a free community luncheon on Friday. This will be at the Transfer Station on Industrial Road and is open to the public.

Ghost on the Coast will be Wednesday, October 31, 2012. Staff is collecting donations and Janice Hamilton is heading up the candy drive.

Commissioner Kennedy shared that a resident has issues with a water heater and feels that the City should take some responsibility for this. There are documented calls to the house to make repairs and flush the hot water heater. Per the customer, the water heater is less than five years old. The house is in the planned new water line section which is good news.

Commissioner Buzzett responded there are school age children in the home and being left without hot water is an issue as well as not having funds to replace it.

Commissioner McCroan noted that the fittings on the heater are not old; there are new type fittings that have only been on the heater for three or four years. He was told the heater was less than four years old.

Mayor Magidson could not say specifically that this is the same water heater, but if it is, the water heater is ten years old. Damage done to the pipes didn't just happen in the last three years. Records were checked and without sharing any names, the unit is ten years old.

Commissioner Patterson also spoke with the individual and questioned who was responsible for the replacement. If you start replacing a hot water heater it opens up problems to replace all water heaters he noted.

Attorney Gibson does not have a position on what should be done but suggested that the gas and power companies be contacted to see what they could do to help with the situations in the future.

Commissioner Buzzett shared that Jonathan Steverson, Executive Director of the Northwest Florida Water Management District, arrived early for the meeting Tuesday and they were able to meet and tour the City's Surface Water Treatment Plant (SWTP). Mr. Steverson and three of his staff; Dave Kozan of CDM; Preble Rish representatives and City Staff participated in a meeting to review and address the issues of the SWTP. Mr. Steverson is proposing to have 20 sites in the City to test water for 1 hour to see what the chemistry of the water is at the home compared to what is coming out of the plant. After that, there will be a pilot study done at the SWTP with some of the old pipes that are coming out of the ground. When all of that is completed, there will be recommendations made for changes as to how to treat the water and eliminate the red water. Unfortunately, this study will take 33 weeks. Money will be provided to pay for the study and will not cost the City other than a few man hours. City Staff will be trained to do the testing in the homes.

Commissioner Patterson asked that a letter be sent to FL DOT concerning the First Street stop light. The letter request will be on the next Commission Agenda.

Commissioner Kennedy requested that Muhly grass planted at all intersections be cut as visibility is an issue.

A Motion was made by Commissioner McCroan, second by Commissioner Patterson, to adjourn the Meeting at 11:28 A.M.

Approved this _____ day of _____ 2012.

Mel C. Magidson, Jr., Mayor

Charlotte M. Pierce, City Clerk

ORDINANCE NO. : 488

AN ORDINANCE OF THE CITY OF PORT ST. JOE, FLORIDA AMENDING ORDINANCE 311, AMENDING THE CHARGE FOR SERVICE CONNECTIONS; PROVIDING FOR CHARGES FOR TRANSFERRING ACCOUNTS; PROVIDING FOR REPEAL OF ALL ORDINANCES OR PARTS OF ORDINANCES IN CONFLICT HEREWITH; PROVIDING FOR SEVERABILITY, AND PROVIDING FOR AN EFFECTIVE DATE.

BE IT ENACTED by the people of the City of Port St. Joe, Florida:

1. That portion of Ordinance 311 which reads:

There shall be a charge of \$10.00 for each service connection and for transferring the utility account from the name of one person to the name of another, which shall be paid before service connection is made or account changed, provided that there shall be no service connection charge or change account charge when a new service connection is made for which a tapping fee is paid.

Is hereby amended to read:

There shall be a charge of \$35.00 for each new service connection and a charge of \$10.00 for transferring the utility account from the name of one person to the name of another, which shall be paid before new service connection is made or account changed, provided that there shall be no new service connection charge or change account charge when a new service connection is made for which a tapping fee is paid.

2. REPEAL:

All ordinances or parts of ordinances in conflict herewith are hereby repealed.

3. SEVERABILITY:

The provisions of this Ordinance are hereby declared to be severable. If any provision of this Ordinance, or the application thereof, to any person or circumstance is held to be invalid, such invalidity shall not affect other provisions or applications of this Ordinance that can be given effect without the invalid provision or application.

4. EFFECTIVE DATE:

This Ordinance shall become effective as provided by law.

DULY PASSED AND ADOPTED by the Board of City Commissioners of Port St. Joe,
Florida this ____ day of _____, 2012.

THE CITY OF PORT ST. JOE

By: _____
MEL C. MAGIDSON, JR.
MAYOR-COMMISSIONER

ATTEST:

CHARLOTTE M. PIERCE
CITY CLERK

The following commissioners voted yea:
The following commissioners voted nay:

W:\City of Port St. Joe\02 Ord ____ amending ord 311-connection fees\Ordinance.doc

ORDINANCE NO. 489

AN ORDINANCE OF THE CITY OF PORT ST. JOE, FLORIDA, AMENDING THE CAPITAL IMPROVEMENTS ELEMENT OF THE COMPREHENSIVE PLAN; AMENDING THE FIVE YEAR CAPITAL IMPROVEMENT PLAN; ADOPTING THE UPDATED SCHOOL DISTRICT FIVE YEAR WORK PLAN; PROVIDING FOR REPEAL OF ALL ORDINANCES OR PARTS OF ORDINANCES IN CONFLICT HEREWITH, PROVIDING FOR SEVERABILITY, AND PROVIDING FOR AN EFFECTIVE DATE.

BE IT ENACTED by the people of Port St. Joe, Florida.

1. The five year Capital Improvement Plan shown in Exhibit "A" is hereby amended as set forth in Exhibit "B".
2. The School District Five Year Work Plan as shown in Exhibit "C" is hereby amended as set forth in Exhibit "D".
3. All ordinances or parts of ordinances in conflict herewith are hereby repealed.
4. If any section, subsection, sentence, clause or provision of this ordinance is invalid, the remainder shall not be affected by such invalidity.
5. This ordinance shall become effective as provided by law.

DULY PASSED AND ADOPTED by the Board of City Commissioners of Port St. Joe, Florida, this ____ day of December, 2012

The City of Port St. Joe

Mel Magidson, Jr.
Mayor-Commissioner

ATTEST:

Charlotte Pierce
City Clerk-Auditor

14

14

PROPOSED FIVE-YEAR SCHEDULE OF CAPITAL IMPROVEMENTS

15

1	Remainder Basin 10 gravity sewer rehabilitation Port St. Joe	Gravity Sewer Rehabilitation	No							\$	1,500,000	Anticipate CDBG Grant
2	Basin 9 gravity sewer rehabilitation Port St. Joe	Yes, Sewer Pg 6 Objective 2.1 Gravity Sewer Rehabilitation	No							\$	2,000,000	Anticipate CDBG Grant
3	Catch Basin 6 PH II Port St. Joe	Yes, Sewer Pg 6 Objective 2.1	No							\$	2,000,000	Anticipate State Revolving Fund
4	1st Street Lift Station Port St. Joe	No	No							\$	800,000	Anticipate State Revolving Fund
5	Lift Station Improvements Port St. Joe	No	No							\$	750,000	Anticipate State Revolving Fund
6	Surface Water Discharge Line Port St. Joe	No	No	\$	4,600							City Budget
7	WWTF Power Improvements Port St. Joe	Upgrade power at plant to include Emergency Power capabilities to buildings	No		\$	75,000						City Budget/Grant Opportunities
8	Solar Aeration for Lagoon Port St. Joe	Replace aging aerators in lagoon with solar power	No	\$	50,000	\$	50,000	\$	50,000	\$	50,000	City Budget/Grant Opportunities

16

1. The first part of the document is a title page. It contains the title "THE HISTORY OF THE UNITED STATES OF AMERICA" and the author "BY JAMES MADISON".

17

GULF COUNTY SCHOOL DISTRICT

2011 - 2012 Work Plan

INTRODUCTION

The 5-Year District Facilities Work Program is a very important document. The Department of Education, Legislature, Governor's Office, Division of Community Planning (growth management), local governments, and others use the work program information for various needs including funding, planning, and as the authoritative source for school facilities related information.

The district's facilities work program must be a complete, balanced capital outlay plan that is financially feasible. The first year of the work program is the district's capital outlay budget. To determine if the work program is balanced and financially feasible, the "Net Available Revenue" minus the "Funded Projects Costs" should sum to zero for "Remaining Funds".

If the "Remaining Funds" balance is zero, then the plan is both balanced and financially feasible.

If the "Remaining Funds" balance is negative, then the plan is neither balanced nor feasible.

If the "Remaining Funds" balance is greater than zero, the plan may be feasible, but it is not balanced.

Summary of revenue/expenditures available for new construction and remodeling projects only.

	2011 - 2012	2012 - 2013	2013 - 2014	2014 - 2015	2015 - 2016	Five Year Total
Total Revenues	\$1,675,676	\$0	\$230,686	\$79,514	\$340,411	\$2,326,487
Total Project Costs	\$1,644,679	\$0	\$0	\$0	\$0	\$1,644,679
Difference (Remaining Funds)	\$31,197	\$0	\$230,686	\$79,514	\$340,411	\$881,808

District

GULF COUNTY SCHOOL DISTRICT

Fiscal Year Range

CERTIFICATION

By submitting this electronic document, we certify that all information provided in this 5-year district facilities work program is accurate, all capital outlay resources are fully reported, and the expenditures planned represent a complete and balanced capital outlay plan for the district. The district Superintendent of Schools, Chief Financial Officer, and the School Board have approved the information contained in this 5-year district facilities work program; they certify to the Department of Education, Office of Educational Facilities, that the information contained herein is correct and accurate; they also certify that the plan has been developed in coordination with the general purpose local governments as required by §1013.38(2) F.S. We understand that any information contained in this 5-year district facilities work program is subject to audit by the Auditor General of the State of Florida.

Date of School Board Adoption	10/8/2011
Work Plan Submittal Date	9/28/2011
DISTRICT SUPERINTENDENT	Jim Norton
CHIEF FINANCIAL OFFICER	Sissy Worley
DISTRICT POINT-OF-CONTACT PERSON	Duane McFarland/Sissy Worley
JOB TITLE	Asst. Superintendent / Finance Officer
PHONE NUMBER	850-228-6256
E-MAIL ADDRESS	dmcfarland@gulf.k12.fl.us

EFIS Home

FISH

Five Year Survey

Five Year Work Plan

Work Plan User Manual

Expenditure

Revenue

Project Schedules

Tracking

Planning

Long Range Planning

Local Governments

Check/Submit Work Plan

Current Work Plan:
2011 - 2012 GULF
COUNTY SCHOOL
DISTRICT

Work Plan -
Submit Work
Plan

User: mcfarland [\[Edit Profile\]](#)
[Logout](#)

Submit Work Plan

The "Save and Submit WorkPlan" screen requires districts to enter all administrative and contact information before submitting the workplan for OEF review and approval.

Congratulations, this Work Plan is complete!

Project Tracking

Expenditures

Expenditure for Maintenance, Repair and Renovation from 1.50-Mills and PECO

Annually, prior to the adoption of the district school budget, each school board must prepare a tentative district facilities work program that includes a schedule of major repair and renovation projects necessary to maintain the educational and ancillary facilities of the district.

HVAC	\$38,750	\$40,000	\$40,000	\$40,000	\$40,000	\$198,750
Locations:	DISTRICT ADMINISTRATIVE OFFICES, HIGHLAND VIEW ELEMENTARY, PORT SAINT JOE ELEMENTARY, PORT SAINT JOE JUNIOR SENIOR HIGH, WEWAHITCHKA ELEMENTARY					
Flooring	\$89,455	\$50,000	\$50,000	\$50,000	\$50,000	\$289,455
Locations:	DISTRICT ADMINISTRATIVE OFFICES, GULF ADULT SCHOOL, PORT SAINT JOE ELEMENTARY, PORT SAINT JOE JUNIOR SENIOR HIGH, WEWAHITCHKA ELEMENTARY					
Roofing	\$125,000	\$0	\$0	\$0	\$0	\$125,000
Locations:	DISTRICT ADMINISTRATIVE OFFICES, GULF ADULT SCHOOL, PORT SAINT JOE ELEMENTARY, PORT SAINT JOE JUNIOR SENIOR HIGH, WEWAHITCHKA ELEMENTARY					
Safety to Life	\$0	\$0	\$0	\$0	\$0	\$0
Locations:	No Locations for this expenditure.					
Fencing	\$18,789	\$0	\$0	\$0	\$0	\$18,789
Locations:	PORT SAINT JOE ELEMENTARY, PORT SAINT JOE JUNIOR SENIOR HIGH, WEWAHITCHKA ELEMENTARY, WEWAHITCHKA JUNIOR SENIOR HIGH					
Painting	\$102,000	\$0	\$0	\$0	\$0	\$102,000
Locations:	WEWAHITCHKA JUNIOR SENIOR HIGH					
Electrical	\$0	\$0	\$0	\$0	\$0	\$0
Locations:	No Locations for this expenditure.					
Fire Alarm	\$0	\$0	\$0	\$0	\$0	\$0
Locations:	No Locations for this expenditure.					
Telephone/Intercom System	\$17,000	\$0	\$0	\$0	\$0	\$17,000
Locations:	WEWAHITCHKA JUNIOR SENIOR HIGH					
Closed Circuit Television	\$0	\$0	\$0	\$0	\$0	\$0
Locations:	No Locations for this expenditure.					
Paint	\$0	\$0	\$0	\$0	\$0	\$0
Locations:	No Locations for this expenditure.					
Maintenance/Repair	\$0	\$0	\$0	\$0	\$0	\$0
Locations:	No Locations for this expenditure.					
Sub Total:	\$391,004	\$90,000	\$90,000	\$90,000	\$90,000	\$751,004

PECO Maintenance Expenditures	\$0	\$88,316	\$196,936	\$241,497	\$259,815	\$786,564
-------------------------------	-----	----------	-----------	-----------	-----------	-----------

1.50 Mill Sub Total:	\$588,773	\$161,884	\$43,084	(\$1,497)	(\$19,815)	\$782,208
----------------------	-----------	-----------	----------	-----------	------------	-----------

Renovate lunchroom	\$30,000	\$0	\$0	\$0	\$0	\$30,000
Locations	PORT SAINT JOE ELEMENTARY					
camera system	\$17,788	\$0	\$0	\$0	\$0	\$17,788
Locations	DISTRICT ADMINISTRATIVE OFFICES, GULF ADULT SCHOOL, PORT SAINT JOE ELEMENTARY, PORT SAINT JOE JUNIOR SENIOR HIGH, WEWAHITCHKA ELEMENTARY, WEWAHITCHKA JUNIOR SENIOR HIGH					
technology	\$150,000	\$150,000	\$150,000	\$150,000	\$150,000	\$750,000
Locations	DISTRICT ADMINISTRATIVE OFFICES, GULF ADULT SCHOOL, PORT SAINT JOE ELEMENTARY, PORT SAINT JOE JUNIOR SENIOR HIGH, WEWAHITCHKA ELEMENTARY, WEWAHITCHKA JUNIOR SENIOR HIGH					
Total:	\$588,773	\$240,000	\$240,000	\$240,000	\$240,000	\$1,848,773

Local 1.50 Mill Expenditure For Maintenance, Repair and Renovation

Anticipated expenditures expected from local funding sources over the years covered by the current work plan.

Remaining Maint and Repair from 1.5 Mills	\$588,773	\$161,884	\$43,084	(\$1,497)	(\$19,815)	\$782,208
Maintenance/Repair Salaries	\$0	\$0	\$0	\$0	\$0	\$0
School Bus Purchases	\$0	\$200,000	\$0	\$220,000	\$0	\$420,000
Other Vehicle Purchases	\$26,949	\$0	\$0	\$0	\$0	\$26,949
Capital Outlay Equipment	\$193,383	\$225,000	\$250,000	\$250,000	\$250,000	\$1,168,383
Rent/Lease Payments	\$0	\$0	\$0	\$0	\$0	\$0
COP Debt Service	\$0	\$0	\$0	\$0	\$0	\$0
Rent/Lease Relocatables	\$12,500	\$0	\$0	\$0	\$0	\$12,500
Environmental Problems	\$0	\$0	\$0	\$0	\$0	\$0
a.1011.14 Debt Service	\$0	\$0	\$0	\$0	\$0	\$0
Special Facilities Construction Account	\$0	\$0	\$0	\$0	\$0	\$0
Premiums for Property Casualty Insurance - 1011.71 (4a,b)	\$190,000	\$190,000	\$190,000	\$190,000	\$190,000	\$950,000
Qualified School Construction Bonds (QSCB)	\$0	\$0	\$0	\$0	\$0	\$0
Qualified Zone Academy Bonds (QZAB)	\$0	\$0	\$0	\$0	\$0	\$0
restroom improvements district wide	\$50,000	\$0	\$0	\$0	\$0	\$50,000
doors (interior & exterior)	\$50,000	\$0	\$0	\$0	\$0	\$50,000
add/renovate classrooms at PSJHS	\$0	\$125,000	\$0	\$0	\$0	\$125,000
Boilers/cooling towers	\$5,111	\$0	\$0	\$0	\$0	\$5,111
Remodel Wewa High	\$15,000	\$0	\$0	\$0	\$0	\$15,000

Remodel County Office	\$21,979	\$0	\$0	\$0	\$0	\$21,979
Local Expenditure Totals:	\$1,163,895	\$891,884	\$483,064	\$658,803	\$420,165	\$3,607,131

Revenue

1.50 Mill Revenue Source

Schedule of Estimated Capital Outlay Revenue from each currently approved source which is estimated to be available for expenditures on the projects included in the tentative district facilities work program. All amounts are NET after considering carryover balances, interest earned, new COP's, 1011.14 and 1011.16 loans, etc. Districts cannot use 1.5-Mill funds for salaries except for those explicitly associated with maintenance/repair projects. (1011.71 (5), F.S.)

(1) Non-exempt property assessed valuation		\$1,618,625,191	\$1,682,707,198	\$1,738,233,192	\$1,823,850,889	\$1,914,815,808	\$8,855,731,878
(2) The Millage projected for discretionary capital outlay per s.1011.71		0.40	0.40	0.40	0.40	0.40	
(3) Full value of the 1.50-Mill discretionary capital outlay per s.1011.71		\$2,551,122	\$2,793,348	\$2,918,872	\$3,083,733	\$3,218,554	\$14,541,829
(4) Value of the portion of the 1.50-Mill ACTUALLY levied	370	\$583,114	\$838,480	\$888,714	\$700,282	\$735,212	\$3,323,802
(5) Difference of lines (3) and (4)		\$1,968,008	\$2,164,868	\$2,260,168	\$2,383,451	\$2,481,342	\$11,217,827

PECO Revenue Source

The figure in the row designated "PECO Maintenance" will be subtracted from funds available for new construction because PECO maintenance dollars cannot be used for new construction.

PECO New Construction	340	\$0	\$0	\$33,503	\$24,202	\$11,851	\$69,658
PECO Maintenance Expenditures		\$0	\$88,318	\$188,938	\$241,497	\$269,815	\$788,584
		\$0	\$88,318	\$230,439	\$265,699	\$271,666	\$856,120

CO & DS Revenue Source

Revenue from Capital Outlay and Debt Service funds.

CO & DS Cash Flow-through Distributed	380	\$12,884	\$12,884	\$12,884	\$12,884	\$12,884	\$83,470
CO & DS Interest on Undistributed CO	380	\$839	\$839	\$839	\$839	\$839	\$4,185
		\$13,533	\$13,533	\$13,533	\$13,533	\$13,533	\$87,655

Fair Share Revenue Source

All legally binding commitments for proportionate fair-share mitigation for impacts on public school facilities must be included in the 5-year district work program.

Nothing reported for this section.

Sales Surtax Referendum

Specific information about any referendum for a 1-cent or 1/2-cent surtax referendum during the previous year.

Did the school district hold a surtax referendum during the past fiscal year 2010 - 2011?

No

Additional Revenue Source

Any additional revenue sources

Revenue Source	2010-2011	2011-2012	2012-2013	2013-2014	2014-2015	2015-2016
Proceeds from a s.1011.14/15 F.S. Loans	\$0	\$0	\$0	\$0	\$0	\$0
District Bonds - Voted local bond referendum proceeds per s.9, Art VII State Constitution	\$0	\$0	\$0	\$0	\$0	\$0
Proceeds from Special Act Bonds	\$0	\$0	\$0	\$0	\$0	\$0
Estimated Revenue from CO & DS Bond Sale	\$0	\$0	\$0	\$0	\$0	\$0
Proceeds from Voted Capital Improvements millage	\$0	\$0	\$0	\$0	\$0	\$0
Other Revenue for Other Capital Projects	\$0	\$0	\$0	\$0	\$0	\$0
Proceeds from 1/2 cent sales surtax authorized by school board	\$0	\$0	\$0	\$0	\$0	\$0
Proceeds from local governmental infrastructure sales surtax	\$0	\$0	\$0	\$0	\$0	\$0
Proceeds from Certificates of Participation (COP's) Sale	\$0	\$0	\$0	\$0	\$0	\$0
Classrooms First Bond proceeds amount authorized in FY 1997-98	\$0	\$0	\$0	\$0	\$0	\$0
Classrooms for Kids	\$0	\$0	\$0	\$0	\$0	\$0
District Equity Recognition	\$0	\$0	\$0	\$0	\$0	\$0
Federal Grants	\$0	\$0	\$0	\$0	\$0	\$0
Proportionate share mitigation (actual cash revenue only, not in kind donations)	\$0	\$0	\$0	\$0	\$0	\$0
Impact fees received	\$0	\$0	\$0	\$0	\$0	\$0
Private donations	\$0	\$0	\$0	\$0	\$0	\$0
Grants from local governments or not-for-profit organizations	\$0	\$0	\$0	\$0	\$0	\$0
Interest, Including Profit On Investment	\$0	\$0	\$0	\$0	\$0	\$0
Revenue from Bonds pledging proceeds from 1 cent or 1/2 cent Sales Surtax	\$0	\$0	\$0	\$0	\$0	\$0

Total Fund Balance Carried Forward	\$2,811,657	\$239,671	\$0	\$0	\$0	\$3,051,528
General Capital Outlay Obligated Fund Balance Carried Forward From Total Fund Balance Carried Forward	\$0	\$0	\$0	\$0	\$0	\$0
Special Facilities Construction Account	\$0	\$0	\$0	\$0	\$0	\$0
One Cent - 1/2 Cent Sales Surtax Debt Service From Total Fund Balance Carried Forward	(\$525,000)	\$0	\$0	\$0	\$0	(\$525,000)
Capital Outlay Projects Funds Balance Carried Forward From Total Fund Balance Carried Forward	(\$53,933)	\$0	\$0	\$0	\$0	(\$53,933)
Subtotal	\$2,232,924	\$239,671	\$0	\$0	\$0	\$2,472,595

Total Revenue Summary

Local 1.5 Mill Discretionary Capital Outlay Revenue	\$583,114	\$536,480	\$686,714	\$709,282	\$735,212	\$3,323,802
PECO and 1.5 Mill Maint and Other 1.5 Mill Expenditures	(\$1,153,695)	(\$891,684)	(\$403,084)	(\$558,503)	(\$420,185)	(\$3,607,131)
PECO Maintenance Revenue	\$0	\$58,316	\$196,936	\$241,497	\$269,616	\$786,664
Available 1.50 Mill for New Construction	(\$570,581)	(\$283,204)	\$183,650	\$41,779	\$316,027	(\$283,329)
CO & DS Revenue	\$13,533	\$13,533	\$13,533	\$13,533	\$13,533	\$67,666
PECO New Construction Revenue	\$0	\$0	\$33,503	\$24,202	\$11,851	\$69,556
Other/Additional Revenue	\$2,232,924	\$239,671	\$0	\$0	\$0	\$2,472,595
Total Additional Revenue	\$2,246,457	\$253,204	\$47,036	\$37,735	\$25,384	\$2,589,516
Total Available Revenue	\$1,876,876	\$0	\$230,686	\$78,514	\$340,411	\$2,326,487

Project Schedules

Capacity Project Schedules

A schedule of capital outlay projects necessary to ensure the availability of satisfactory classrooms for the projected student enrollment in K-12 programs.

Purchase relocatable (m 8) - funded from LCI	WEWAHITCHKA JUNIOR SENIOR HIGH	Planned Cost:	\$12,500	\$0	\$0	\$0	\$0	\$12,500	Yes
Student Stations:			25	0	0	0	0	25	
Total Classrooms:			1	0	0	0	0	1	
Gross Sq Ft:			884	0	0	0	0	884	

Planned Cost:	\$12,500	\$0	\$0	\$0	\$0	\$12,500
Student Stations:	25	0	0	0	0	25
Total Classrooms:	1	0	0	0	0	1
Gross Sq Ft:	884	0	0	0	0	884

Other Project Schedules

Major renovations, remodeling, and additions of capital outlay projects that do not add capacity to schools.

covered outdoor p.e. facility	WEWAHITCHKA ELEMENTARY	\$158,010	\$0	\$0	\$0	\$0	\$158,010	Yes
Remodel Lunchroom	PORT SAINT JOE ELEMENTARY	\$1,000,000	\$0	\$0	\$0	\$0	\$1,000,000	Yes
roof at Wewa Elementary	WEWAHITCHKA ELEMENTARY	\$474,169	\$0	\$0	\$0	\$0	\$474,169	Yes
		\$1,632,179	\$0	\$0	\$0	\$0	\$1,632,179	

Additional Project Schedules

Any projects that are not identified in the last approved educational plant survey.

Project description not specified	Location not specified	\$0	\$0	\$0	\$0	\$0	\$0	No
		\$0	\$0	\$0	\$0	\$0	\$0	

Non Funded Growth Management Project Schedules

Schedule indicating which projects, due to planned development, that CANNOT be funded from current revenues projected over the next five years.

Nothing reported for this section.

Tracking

Capacity Tracking

WEWAHITCHKA ELEMENTARY	567	567	393	30	13	69.00 %	0	0	0	0.00 %	0
PORT SAINT JOE ELEMENTARY	760	760	485	37	13	64.00 %	0	0	0	0.00 %	0
PORT SAINT JOE JUNIOR SENIOR HIGH	1,108	997	695	47	13	60.00 %	0	0	0	0.00 %	0
HIGHLAND VIEW ELEMENTARY	0	0	0	0	0	0.00 %	0	0	0	0.00 %	0
WEWAHITCHKA JUNIOR SENIOR HIGH	768	707	454	35	13	64.00 %	0	0	0	0.00 %	0
GULF ADULT SCHOOL	72	108	3	3	1	3.00 %	0	0	0	0.00 %	0
	3,293	3,139	1,930	162	13	61.47 %	0	0	0	0.00 %	0

The COFTE Projected Total (0) for 2015 - 2016 must match the Official Forecasted COFTE Total (1,882) for 2015 - 2016 before this section can be completed. In the event that the COFTE Projected Total does not match the Official forecasted COFTE, then the Balanced Projected COFTE Table would be used to balance COFTE.

Elementary (PK-3)	671
Middle (4-8)	677
High (9-12)	514
	1,862

Elementary (PK-3)	671
Middle (4-8)	677
High (9-12)	514
	1,862

Relocatable Replacement

Number of relocatable classrooms clearly identified and scheduled for replacement in the school board adopted financially feasible 5-year district work program.

Total Relocatable Replacements:	0	0	0	0	0	0
---------------------------------	---	---	---	---	---	---

Charter Schools Tracking

Information regarding the use of charter schools.

Nothing reported for this section.

Special Purpose Classrooms Tracking

The number of classrooms that will be used for certain special purposes in the current year, by facility and type of classroom, that the district will, 1), not use for educational purposes, and 2), the co-teaching classrooms that are not open plan classrooms and will be used for educational purposes.

Facility	Type	2011	2012	2013	2014	2015	2016
PORT SAINT JOE ELEMENTARY	Educational	0	2	0	0	0	2
PORT SAINT JOE JUNIOR SENIOR HIGH	Educational	0	0	2	0	0	2
WEWAHITCHKA JUNIOR SENIOR HIGH	Educational	0	0	2	0	0	2
Total Educational Classrooms:		0	2	4	0	0	6

Facility	Type	2011	2012	2013	2014	2015	2016
PORT SAINT JOE ELEMENTARY	Co-Teaching	0	2	0	0	0	2
PORT SAINT JOE JUNIOR SENIOR HIGH	Co-Teaching	0	0	2	0	0	2
WEWAHITCHKA JUNIOR SENIOR HIGH	Co-Teaching	0	0	2	0	0	2
Total Co-Teaching Classrooms:		0	2	4	0	0	6

Infrastructure Tracking

Necessary offsite infrastructure requirements resulting from expansions or new schools. This section should include infrastructure information related to capacity project schedules and other project schedules (Section 4).

Not Specified

Proposed location of planned facilities, whether those locations are consistent with the comprehensive plans of all affected local governments, and recommendations for infrastructure and other improvements to land adjacent to existing facilities. Provisions of 1013.33(12), (13) and (14) and 1013.38 must be addressed for new facilities planned within the first three years of the plan (Section 5).

Not Specified

Consistent with Comp Plan? No

Net New Classrooms

The number of classrooms, by grade level and type of construction, that were added during the last fiscal year.

List the net new classrooms added in the 2010 - 2011 fiscal year.					List the net new classrooms to be added in the 2011 - 2012 fiscal year.			
"Classrooms" is defined as capacity carrying classrooms that are added to increase capacity to enable the district to meet the Class Size Amendment.					Totals for fiscal year 2011 - 2012 should match totals in Section 15A.			
Elementary (PK-3)	0	0	0	0	0	0	0	0
Middle (4-8)	0	0	0	0	0	0	0	0
High (9-12)	0	0	0	0	1	0	0	1
	0	0	0	0	1	0	0	1

Relocatable Student Stations

Number of students that will be educated in relocatable units, by school, in the current year, and the projected number of students for each of the years in the workplan.

PORT SAINT JOE JUNIOR SENIOR HIGH	0	128	128	128	0	78
HIGHLAND VIEW ELEMENTARY	0	0	0	0	0	0
WEWAHITCHKA JUNIOR SENIOR HIGH	0	168	168	168	0	95
GULF ADULT SCHOOL	0	0	0	0	0	0
WEWAHITCHKA ELEMENTARY	25	18	18	18	0	18
PORT SAINT JOE ELEMENTARY	0	0	0	0	0	0

Total students in relocatables by year.	25	302	302	302	0	188
Total number of COFTE students projected by year.	1,958	1,868	1,881	1,873	1,882	1,868
Percent in relocatables by year.	1 %	16 %	16 %	16 %	0 %	10 %

Leased Facilities Tracking

Existing leased facilities and plans for the acquisition of leased facilities, including the number of classrooms and student stations, as reported in the educational plant survey, that are planned in that location at the end of the five year workplan.

WEWAHITCHKA ELEMENTARY	1	25		0	0
PORT SAINT JOE ELEMENTARY	0	0		0	0
PORT SAINT JOE JUNIOR SENIOR HIGH	0	0		0	0
HIGHLAND VIEW ELEMENTARY	0	0		0	0
WEWAHITCHKA JUNIOR SENIOR HIGH	0	0		0	0

GULF ADULT SCHOOL	0	0		0	0
	1	25		0	0

Failed Standard Relocatable Tracking

Relocatable units currently reported by school, from FISH, and the number of relocatable units identified as 'Failed Standards'.

Nothing reported for this section.

Planning**Class Size Reduction Planning**

Plans approved by the school board that reduce the need for permanent student stations such as acceptable school capacity levels, redistricting, busing, year-round schools, charter schools, magnet schools, public-private partnerships, multitrack scheduling, grade level organization, block scheduling, or other alternatives.

Other than hiring new teachers there is space available to meet the requirements for class size reduction. There could possibly be a need for three new classrooms at Port St. Joe Elementary School. However, projected COFTE numbers are predicted to drop in the next five years reducing the need for new classrooms.

School Closure Planning

Plans for the closure of any school, including plans for disposition of the facility or usage of facility space, and anticipated revenues.

No schools will be closed in Gulf County

Five Year Survey - Ten Year Capacity

GULF COUNTY SCHOOL DISTRICT

9/28/2011

Schedule of capital outlay projects projected to ensure the availability of satisfactory student stations for the projected student enrollment in K - 12 programs for the future 5 years beyond the 5-year district facilities work program.

No items meet the criteria.

Five Year Survey - Ten Year Infrastructure

GULF COUNTY SCHOOL DISTRICT

9/28/2011

Proposed Location of Planned New, Remodeled, or New Additions to Facilities in 6 thru 10 out years (Section 28).

No items meet the criteria.

Plans for closure of any school, including plans for disposition of the facility or usage of facility space, and anticipated revenues in the 6 thru 10 out years (Section 29).

No items meet the criteria.

Five Year Survey - Ten Year Maintenance

GULF COUNTY SCHOOL DISTRICT

9/28/2011

District projects and locations regarding the projected need for major renovation, repair, and maintenance projects within the district in years 6 - 10 beyond the projects plans detailed in the five years covered by the work plan.

No items match the criteria.

Five Year Survey - Ten Year Utilization

GULF COUNTY SCHOOL DISTRICT

9/28/2011

Schedule of planned capital outlay projects identifying the standard grade groupings, capacities, and planned utilization rates of future educational facilities of the district for both permanent and relocatable facilities.

Elementary - District Totals	1,327	1,327	870.60	65.61 %	0	0	0.00 %
Middle - District Totals	0	0	0.00	#Error	0	0	#Error
High - District Totals	1,918	1,726	1,121.46	64.97 %	0	0	0.00 %
Other - ESE, etc	140	183	5.50	3.01 %	0	0	0.00 %
	3,385	3,236	1,997.56	61.73 %	0	0	0.00 %

Combination schools are included with the middle schools for student stations, capacity, COFTE and utilization purposes because these facilities all have a 90% utilization factor. Use this space to explain or define the grade groupings for combination schools.

No comments to report.

Five Year Survey - Twenty Year Capacity

GULF COUNTY SCHOOL DISTRICT

9/28/2011

Schedule of capital outlay projects projected to ensure the availability of satisfactory student stations for the projected student enrollment in K - 12 programs for the future 11 - 20 years beyond the 5-year district facilities work program.

No items match the criteria.

Five Year Survey - Twenty Year Infrastructure

GULF COUNTY SCHOOL DISTRICT

9/28/2011

Proposed Location of Planned New, Remodeled, or New Additions to Facilities in the 11 through 20 out years (Section 28).

No items meet the criteria.

Plans for closure of any school, including plans for disposition of the facility or usage of facility space, and anticipated revenues in the 11 through 20 out years (Section 29).

No items meet the criteria.

Five Year Survey - Twenty Year Maintenance

GULF COUNTY SCHOOL DISTRICT

9/28/2011

District projects and locations regarding the projected need for major renovation, repair, and maintenance projects within the district in years 11 - 20 beyond the projects plans detailed in the five years covered by the work plan.

No items match the criteria.

Five Year Survey - Twenty Year Utilization

GULF COUNTY SCHOOL DISTRICT

9/28/2011

Schedule of planned capital outlay projects identifying the standard grade groupings, capacities, and planned utilization rates of future educational facilities of the district for both permanent and relocatable facilities.

Elementary - District Totals	1,327	1,327	870.80	65.61 %	0	0	0.00 %
Middle - District Totals	0	0	0.00	#Error	0	0	#Error
High - District Totals	1,918	1,728	1,121.46	64.97 %	0	0	0.00 %
Other - ESE, etc	140	183	5.50	3.01 %	0	0	0.00 %
	3,385	3,236	1,997.56	61.73 %	0	0	0.00 %

Combination schools are included with the middle schools for student stations, capacity, COFTE and utilization purposes because these facilities all have a 90% utilization factor. Use this space to explain or define the grade groupings for combination schools.

No comments to report.

INTRODUCTION

The 5-Year District Facilities Work Program is a very important document. The Department of Education, Legislature, Governor's Office, Division of Community Planning (growth management), local governments, and others use the work program information for various needs including funding, planning, and as the authoritative source for school facilities related information.

The district's facilities work program must be a complete, balanced capital outlay plan that is financially feasible. The first year of the work program is the districts capital outlay budget. To determine if the work program is balanced and financially feasible, the "Net Available Revenue" minus the "Funded Projects Costs" should sum to zero for "Remaining Funds".

If the "Remaining Funds" balance is zero, then the plan is both balanced and financially feasible.

If the "Remaining Funds" balance is negative, then the plan is neither balanced nor feasible.

If the "Remaining Funds" balance is greater than zero, the plan may be feasible, but it is not balanced.

Summary of revenue/expenditures available for new construction and remodeling projects only.

	2012 - 2013	2013 - 2014	2014 - 2015	2015 - 2016	2016 - 2017	Five Year Total
Total Revenues	\$1,045,961	(\$924,296)	(\$818,226)	(\$582,191)	\$10,069	(\$1,268,683)
Total Project Costs	\$1,045,938	\$0	\$0	\$0	\$0	\$1,045,938
Difference (Remaining Funds)	\$23	(\$924,296)	(\$818,226)	(\$582,191)	\$10,069	(\$2,314,621)

District

GULF COUNTY SCHOOL DISTRICT

Fiscal Year Range**CERTIFICATION**

By submitting this electronic document, we certify that all information provided in this 5-year district facilities work program is accurate, all capital outlay resources are fully reported, and the expenditures planned represent a complete and balanced capital outlay plan for the district. The district Superintendent of Schools, Chief Financial Officer, and the School Board have approved the information contained in this 5-year district facilities work program; they certify to the Department of Education, Office of Educational Facilities, that the information contained herein is correct and accurate; they also certify that the plan has been developed in coordination with the general purpose local governments as required by §1013.35(2) F.S. We understand that any information contained in this 5-year district facilities work program is subject to audit by the Auditor General of the State of Florida.

Date of School Board Adoption	11/8/2012
Work Plan Submittal Date	10/4/2012
DISTRICT SUPERINTENDENT	Jim Norton
CHIEF FINANCIAL OFFICER	Sissy Worley
DISTRICT POINT-OF-CONTACT PERSON	Duane McFarland
JOB TITLE	Assistant Superintendent
PHONE NUMBER	850-229-8256
E-MAIL ADDRESS	dmcfarland@gulf.k12.fl.us

Expenditures

Expenditure for Maintenance, Repair and Renovation from 1.50-Mills and PECO

Annually, prior to the adoption of the district school budget, each school board must prepare a tentative district facilities work program that includes a schedule of major repair and renovation projects necessary to maintain the educational and ancillary facilities of the district.

Item	2012 - 2013 Actual Budget	2013 - 2014 Projected	2014 - 2015 Projected	2015 - 2016 Projected	2016 - 2017 Projected	Total
HVAC	\$40,000	\$40,000	\$40,000	\$40,000	\$40,000	\$200,000
Locations:	DISTRICT ADMINISTRATIVE OFFICES, GULF ADULT SCHOOL, PORT SAINT JOE ELEMENTARY, PORT SAINT JOE JUNIOR SENIOR HIGH, WEWAHITCHKA ELEMENTARY, WEWAHITCHKA JUNIOR SENIOR HIGH					
Flooring	\$50,000	\$50,000	\$50,000	\$50,000	\$50,000	\$250,000
Locations:	DISTRICT ADMINISTRATIVE OFFICES, GULF ADULT SCHOOL, PORT SAINT JOE ELEMENTARY, PORT SAINT JOE JUNIOR SENIOR HIGH, WEWAHITCHKA ELEMENTARY					
Roofing	\$75,230	\$0	\$0	\$0	\$0	\$75,230
Locations:	DISTRICT ADMINISTRATIVE OFFICES, GULF ADULT SCHOOL, PORT SAINT JOE ELEMENTARY, PORT SAINT JOE JUNIOR SENIOR HIGH, WEWAHITCHKA ELEMENTARY, WEWAHITCHKA JUNIOR SENIOR HIGH					
Safety to Life	\$0	\$0	\$0	\$0	\$0	\$0
Locations:	No Locations for this expenditure.					
Fencing	\$0	\$0	\$0	\$0	\$0	\$0
Locations:	No Locations for this expenditure.					
Parking	\$58,000	\$0	\$0	\$0	\$0	\$58,000
Locations:	PORT SAINT JOE ELEMENTARY					
Electrical	\$0	\$0	\$0	\$0	\$0	\$0
Locations:	No Locations for this expenditure.					
Fire Alarm	\$0	\$0	\$0	\$0	\$0	\$0
Locations:	No Locations for this expenditure.					
Telephone/Intercom System	\$0	\$0	\$0	\$0	\$0	\$0
Locations:	No Locations for this expenditure.					
Closed Circuit Television	\$0	\$0	\$0	\$0	\$0	\$0
Locations:	No Locations for this expenditure.					
Paint	\$0	\$0	\$0	\$0	\$0	\$0
Locations:	No Locations for this expenditure.					
Maintenance/Repair	\$59,643	\$60,000	\$60,000	\$60,000	\$70,000	\$309,643
Locations:	DISTRICT ADMINISTRATIVE OFFICES, GULF ADULT SCHOOL, PORT SAINT JOE ELEMENTARY, PORT SAINT JOE JUNIOR SENIOR HIGH, WEWAHITCHKA ELEMENTARY, WEWAHITCHKA JUNIOR SENIOR HIGH					
Sub Total:	\$282,873	\$150,000	\$150,000	\$150,000	\$160,000	\$892,873

PECO Maintenance Expenditures	\$0	\$0	\$119,259	\$139,797	\$154,365	\$413,421
-------------------------------	-----	-----	-----------	-----------	-----------	-----------

1.50 Mill Sub Total:	\$1,301,871	\$300,000	\$180,741	\$160,203	\$5,635	\$1,948,450
-----------------------------	-------------	-----------	-----------	-----------	---------	-------------

Other Items	2012 - 2013 Actual Budget	2013 - 2014 Projected	2014 - 2015 Projected	2015 - 2016 Projected	2016 - 2017 Projected	Total
Renovate lunchroom	\$518,608	\$0	\$0	\$0	\$0	\$518,608
Locations	PORT SAINT JOE ELEMENTARY					
technology	\$75,000	\$150,000	\$150,000	\$150,000	\$0	\$525,000
Locations	DISTRICT ADMINISTRATIVE OFFICES, GULF ADULT SCHOOL, PORT SAINT JOE ELEMENTARY, PORT SAINT JOE JUNIOR SENIOR HIGH, WEWAHITCHKA ELEMENTARY, WEWAHITCHKA JUNIOR SENIOR HIGH					
PE Classrooms	\$425,390	\$0	\$0	\$0	\$0	\$425,390
Locations	PORT SAINT JOE JUNIOR SENIOR HIGH					
Total:	\$1,301,871	\$300,000	\$300,000	\$300,000	\$160,000	\$2,361,871

Local 1.50 Mill Expenditure For Maintenance, Repair and Renovation

Anticipated expenditures expected from local funding sources over the years covered by the current work plan.

Item	2012 - 2013 Actual Budget	2013 - 2014 Projected	2014 - 2015 Projected	2015 - 2016 Projected	2016 - 2017 Projected	Total
Remaining Maint and Repair from 1.5 Mills	\$1,301,871	\$300,000	\$180,741	\$160,203	\$5,635	\$1,948,450
Maintenance/Repair Salaries	\$0	\$0	\$0	\$0	\$0	\$0
School Bus Purchases	\$0	\$200,000	\$220,000	\$0	\$0	\$420,000
Other Vehicle Purchases	\$0	\$0	\$0	\$0	\$0	\$0
Capital Outlay Equipment	\$75,000	\$250,000	\$250,000	\$250,000	\$0	\$825,000
Rent/Lease Payments	\$0	\$0	\$0	\$0	\$0	\$0
COP Debt Service	\$0	\$0	\$0	\$0	\$0	\$0
Rent/Lease Relocatables	\$0	\$0	\$0	\$0	\$0	\$0
Environmental Problems	\$0	\$0	\$0	\$0	\$0	\$0
s.1011.14 Debt Service	\$0	\$0	\$0	\$0	\$0	\$0
Special Facilities Construction Account	\$0	\$0	\$0	\$0	\$0	\$0
Premiums for Property Casualty Insurance - 1011.71 (4a,b)	\$190,000	\$190,000	\$190,000	\$190,000	\$0	\$760,000
Qualified School Construction Bonds (QSCB)	\$0	\$0	\$0	\$0	\$0	\$0
Qualified Zone Academy Bonds (QZAB)	\$0	\$0	\$0	\$0	\$0	\$0
Covered Play	\$10,432	\$0	\$0	\$0	\$0	\$10,432
Local Expenditure Totals:	\$1,577,303	\$940,000	\$840,741	\$600,203	\$5,635	\$3,963,882

Revenue

1.50 Mill Revenue Source

Schedule of Estimated Capital Outlay Revenue from each currently approved source which is estimated to be available for expenditures on the projects included in the tentative district facilities work program. All amounts are NET after considering carryover balances, interest earned, new COP's, 1011.14 and 1011.15 loans, etc. Districts cannot use 1.5-Mill funds for salaries except for those explicitly associated with maintenance/repair projects. (1011.71 (5), F.S.)

Item	Fund	2012 - 2013 Actual Value	2013 - 2014 Projected	2014 - 2015 Projected	2015 - 2016 Projected	2016 - 2017 Projected	Total
(1) Non-exempt property assessed valuation		\$1,406,159,594	\$1,493,258,904	\$1,533,674,256	\$1,578,852,254	\$1,638,945,615	\$7,650,890,623
(2) The Millege projected for discretionary capital outlay per s.1011.71		0.40	0.00	0.00	0.00	0.00	
(3) Full value of the 1.50-Mill discretionary capital outlay per s.1011.71		\$2,362,348	\$2,508,675	\$2,576,573	\$2,652,472	\$2,753,429	\$12,853,497
(4) Value of the portion of the 1.50 -Mill ACTUALLY levied	370	\$539,965	\$0	\$0	\$0	\$0	\$539,965
(5) Difference of lines (3) and (4)		\$1,822,383	\$2,508,675	\$2,576,573	\$2,652,472	\$2,753,429	\$12,313,532

PECO Revenue Source

The figure in the row designated "PECO Maintenance" will be subtracted from funds available for new construction because PECO maintenance dollars cannot be used for new construction.

Item	Fund	2012 - 2013 Actual Budget	2013 - 2014 Projected	2014 - 2015 Projected	2015 - 2016 Projected	2016 - 2017 Projected	Total
PECO New Construction	340	\$0	\$0	\$6,811	\$2,308	\$0	\$9,119
PECO Maintenance Expenditures		\$0	\$0	\$119,259	\$139,797	\$154,365	\$413,421
		\$0	\$0	\$126,070	\$142,105	\$154,365	\$422,540

CO & DS Revenue Source

Revenue from Capital Outlay and Debt Service funds.

Item	Fund	2012 - 2013 Actual Budget	2013 - 2014 Projected	2014 - 2015 Projected	2015 - 2016 Projected	2016 - 2017 Projected	Total
CO & DS Cash Flow-through Distributed	360	\$14,917	\$14,917	\$14,917	\$14,917	\$14,917	\$74,585
CO & DS Interest on Undistributed CO	360	\$787	\$787	\$787	\$787	\$787	\$3,935
		\$15,704	\$15,704	\$15,704	\$15,704	\$15,704	\$78,520

Fair Share Revenue Source

All legally binding commitments for proportionate fair-share mitigation for impacts on public school facilities must be included in the 5-year district work program.

Nothing reported for this section.

Sales Surtax Referendum

Specific information about any referendum for a 1-cent or ½-cent surtax referendum during the previous year.

Did the school district hold a surtax referendum during the past fiscal year 2011 - 2012?

No

Additional Revenue Source

Any additional revenue sources

Item	2012 - 2013 Actual Value	2013 - 2014 Projected	2014 - 2015 Projected	2015 - 2016 Projected	2016 - 2017 Projected	Total
Proceeds from a s.1011.14/15 F.S. Loans	\$0	\$0	\$0	\$0	\$0	\$0
District Bonds - Voted local bond referendum proceeds per s.9, Art VII State Constitution	\$0	\$0	\$0	\$0	\$0	\$0
Proceeds from Special Act Bonds	\$0	\$0	\$0	\$0	\$0	\$0
Estimated Revenue from CO & DS Bond Sale	\$0	\$0	\$0	\$0	\$0	\$0
Proceeds from Voted Capital Improvements millage	\$0	\$0	\$0	\$0	\$0	\$0
Other Revenue for Other Capital Projects	\$0	\$0	\$0	\$0	\$0	\$0
Proceeds from 1/2 cent sales surtax authorized by school board	\$0	\$0	\$0	\$0	\$0	\$0
Proceeds from local governmental infrastructure sales surtax	\$0	\$0	\$0	\$0	\$0	\$0
Proceeds from Certificates of Participation (COP's) Sale	\$0	\$0	\$0	\$0	\$0	\$0
Classrooms First Bond proceeds amount authorized in FY 1997-98	\$0	\$0	\$0	\$0	\$0	\$0
Classrooms for Kids	\$0	\$0	\$0	\$0	\$0	\$0
District Equity Recognition	\$0	\$0	\$0	\$0	\$0	\$0
Federal Grants	\$0	\$0	\$0	\$0	\$0	\$0
Proportionate share mitigation (actual cash revenue only, not in kind donations)	\$0	\$0	\$0	\$0	\$0	\$0
Impact fees received	\$0	\$0	\$0	\$0	\$0	\$0
Private donations	\$0	\$0	\$0	\$0	\$0	\$0
Grants from local governments or not-for-profit organizations	\$0	\$0	\$0	\$0	\$0	\$0
Interest, Including Profit On Investment	\$0	\$0	\$0	\$0	\$0	\$0
Revenue from Bonds pledging proceeds from 1 cent or 1/2 cent Sales Surtax	\$0	\$0	\$0	\$0	\$0	\$0
Total Fund Balance Carried Forward	\$2,067,595	\$0	\$0	\$0	\$0	\$2,067,595
General Capital Outlay Obligated Fund Balance Carried Forward From Total Fund Balance Carried Forward	\$0	\$0	\$0	\$0	\$0	\$0
Special Facilities Construction Account	\$0	\$0	\$0	\$0	\$0	\$0
One Cent - 1/2 Cent Sales Surtax Debt Service From Total Fund Balance Carried Forward	\$0	\$0	\$0	\$0	\$0	\$0

Capital Outlay Projects Funds Balance Carried Forward From Total Fund Balance Carried Forward	\$0	\$0	\$0	\$0	\$0	\$0
Subtotal	\$2,067,595	\$0	\$0	\$0	\$0	\$2,067,595

Total Revenue Summary

Item Name	2012 - 2013 Budget	2013 - 2014 Projected	2014 - 2015 Projected	2015 - 2016 Projected	2016 - 2017 Projected	Five Year Total
Local 1.5 Mill Discretionary Capital Outlay Revenue	\$539,965	\$0	\$0	\$0	\$0	\$539,965
PECO and 1.5 Mill Maint and Other 1.5 Mill Expenditures	(\$1,577,303)	(\$940,000)	(\$840,741)	(\$600,203)	(\$5,635)	(\$3,963,882)
PECO Maintenance Revenue	\$0	\$0	\$119,259	\$139,797	\$154,365	\$413,421
Available 1.50 Mill for New Construction	(\$1,037,338)	(\$940,000)	(\$840,741)	(\$600,203)	(\$5,635)	(\$3,423,917)

Item Name	2012 - 2013 Budget	2013 - 2014 Projected	2014 - 2015 Projected	2015 - 2016 Projected	2016 - 2017 Projected	Five Year Total
CO & DS Revenue	\$15,704	\$15,704	\$15,704	\$15,704	\$15,704	\$78,520
PECO New Construction Revenue	\$0	\$0	\$6,811	\$2,308	\$0	\$9,119
Other/Additional Revenue	\$2,067,595	\$0	\$0	\$0	\$0	\$2,067,595
Total Additional Revenue	\$2,083,299	\$15,704	\$22,515	\$18,012	\$15,704	\$2,155,234
Total Available Revenue	\$1,045,961	(\$924,296)	(\$818,226)	(\$582,191)	\$10,069	(\$1,268,683)

Project Schedules

Capacity Project Schedules

A schedule of capital outlay projects necessary to ensure the availability of satisfactory classrooms for the projected student enrollment in K-12 programs.

Nothing reported for this section.

Planned Cost:						
Student Stations:						
Total Classrooms:						
Gross Sq Ft:						

Other Project Schedules

Major renovations, remodeling, and additions of capital outlay projects that do not add capacity to schools.

Project Description	Location	2012 - 2013 Actual Budget	2013 - 2014 Projected	2014 - 2015 Projected	2015 - 2016 Projected	2016 - 2017 Projected	Total	Funded
covered outdoor p.e. facility	WEWAHITCHKA ELEMENTARY	\$10,431	\$0	\$0	\$0	\$0	\$10,431	Yes
Remodel Lunchroom	PORT SAINT JOE ELEMENTARY	\$518,608	\$0	\$0	\$0	\$0	\$518,608	Yes
new roof at Wewa Elementary	WEWAHITCHKA ELEMENTARY	\$181,509	\$0	\$0	\$0	\$0	\$181,509	Yes
Remodel dressing area/PE classrooms	PORT SAINT JOE JUNIOR SENIOR HIGH	\$335,390	\$0	\$0	\$0	\$0	\$335,390	Yes
Roof cleaning	PORT SAINT JOE JUNIOR SENIOR HIGH	\$0	\$0	\$0	\$0	\$0	\$0	No
Project description not specified	Location not specified	\$0	\$0	\$0	\$0	\$0	\$0	No
Project description not specified	Location not specified	\$0	\$0	\$0	\$0	\$0	\$0	No
Project description not specified	Location not specified	\$0	\$0	\$0	\$0	\$0	\$0	No
Project description not specified	Location not specified	\$0	\$0	\$0	\$0	\$0	\$0	No
Project description not specified	Location not specified	\$0	\$0	\$0	\$0	\$0	\$0	No
		\$1,045,938	\$0	\$0	\$0	\$0	\$1,045,938	

Additional Project Schedules

Any projects that are not identified in the last approved educational plant survey.

Project Description	Location	Num Classroom s	2012 - 2013 Actual Budget	2013 - 2014 Projected	2014 - 2015 Projected	2015 - 2016 Projected	2016 - 2017 Projected	Total	Funded
Project description not specified	Location not specified		\$0	\$0	\$0	\$0	\$0	\$0	No
			\$0	\$0	\$0	\$0	\$0	\$0	

Non Funded Growth Management Project Schedules

Schedule indicating which projects, due to planned development, that CANNOT be funded from current revenues projected over the next five years.

Nothing reported for this section.

Tracking

Capacity Tracking

Location	2012 - 2013 Satis. Stu. Sta.	Actual 2012 - 2013 FISH Capacity	Actual 2011 - 2012 COFTE	# Class Rooms	Actual Average 2012 - 2013 Class Size	Actual 2012 - 2013 Utilization	New Stu. Capacity	New Rooms to be Added/Removed	Projected 2016 - 2017 COFTE	Projected 2016 - 2017 Utilization	Projected 2016 - 2017 Class Size
WEWAHITCHKA ELEMENTARY	567	567	445	30	15	78.00 %	0	0	0	0.00 %	0
PORT SAINT JOE ELEMENTARY	760	760	557	37	15	73.00 %	0	0	0	0.00 %	0
PORT SAINT JOE JUNIOR SENIOR HIGH	1,108	997	493	47	10	49.00 %	0	0	0	0.00 %	0
HIGHLAND VIEW ELEMENTARY	0	0	0	0	0	0.00 %	0	0	0	0.00 %	0
WEWAHITCHKA JUNIOR SENIOR HIGH	786	707	384	35	11	54.00 %	0	0	0	0.00 %	0
GULF ADULT SCHOOL	72	108	1	3	0	1.00 %	0	0	0	0.00 %	0
	3,293	3,139	1,880	152	12	59.88 %	0	0	0	0.00 %	0

The COFTE Projected Total (0) for 2016 - 2017 must match the Official Forecasted COFTE Total (1,869) for 2016 - 2017 before this section can be completed. In the event that the COFTE Projected Total does not match the Official forecasted COFTE, then the Balanced Projected COFTE Table should be used to balance COFTE.

Projected COFTE for 2016 - 2017	
Elementary (PK-3)	577
Middle (4-8)	754
High (9-12)	537
	1,869

Grade Level Type	Balanced Projected COFTE for 2016 - 2017
Elementary (PK-3)	577
Middle (4-8)	754
High (9-12)	537
	1,868

Relocatable Replacement

Number of relocatable classrooms clearly identified and scheduled for replacement in the school board adopted financially feasible 5-year district work program.

Location	2012 - 2013	2013 - 2014	2014 - 2015	2015 - 2016	2016 - 2017	Year 5 Total
Total Relocatable Replacements:	0	0	0	0	0	0

Charter Schools Tracking

Information regarding the use of charter schools.

Nothing reported for this section.

Special Purpose Classrooms Tracking

The number of classrooms that will be used for certain special purposes in the current year, by facility and type of classroom, that the district will, 1), not use for educational purposes, and 2), the co-teaching classrooms that are not open plan classrooms and will be used for educational purposes.

School	School Type	# of Elementary K-3 Classrooms	# of Middle 4-8 Classrooms	# of High 9-12 Classrooms	# of ESE Classrooms	# of Combo Classrooms	Total Classrooms
PORT SAINT JOE ELEMENTARY	Educational	0	2	0	0	0	2
PORT SAINT JOE JUNIOR SENIOR HIGH	Educational	0	0	2	0	0	2
WEWAHITCHKA JUNIOR SENIOR HIGH	Educational	0	0	2	0	0	2
Total Educational Classrooms:		0	2	4	0	0	6

School	School Type	# of Elementary K-3 Classrooms	# of Middle 4-8 Classrooms	# of High 9-12 Classrooms	# of ESE Classrooms	# of Combo Classrooms	Total Classrooms
PORT SAINT JOE ELEMENTARY	Co-Teaching	0	2	0	0	0	2
PORT SAINT JOE JUNIOR SENIOR HIGH	Co-Teaching	0	0	2	0	0	2
WEWAHITCHKA JUNIOR SENIOR HIGH	Co-Teaching	0	0	2	0	0	2
Total Co-Teaching Classrooms:		0	2	4	0	0	6

Infrastructure Tracking

Necessary offsite infrastructure requirements resulting from expansions or new schools. This section should include infrastructure information related to capacity project schedules and other project schedules (Section 4).

Not Specified

Proposed location of planned facilities, whether those locations are consistent with the comprehensive plans of all affected local governments, and recommendations for infrastructure and other improvements to land adjacent to existing facilities. Provisions of 1013.33(12), (13) and (14) and 1013.36 must be addressed for new facilities planned within the 1st three years of the plan (Section 5).

Not Specified

Consistent with Comp Plan? No

Net New Classrooms

The number of classrooms, by grade level and type of construction, that were added during the last fiscal year.

List the net new classrooms added in the 2011 - 2012 fiscal year.					List the net new classrooms to be added in the 2012 - 2013 fiscal year.			
"Classrooms" is defined as capacity carrying classrooms that are added to increase capacity to enable the district to meet the Class Size Amendment.					Totals for fiscal year 2012 - 2013 should match totals in Section 15A.			
Location	2011 - 2012 # Permanent	2011 - 2012 # Modular	2011 - 2012 # Relocatable	2011 - 2012 Total	2012 - 2013 # Permanent	2012 - 2013 # Modular	2012 - 2013 # Relocatable	2012 - 2013 Total
Elementary (PK-3)	0	0	0	0	0	0	0	0
Middle (4-8)	0	0	0	0	0	0	0	0
High (9-12)	0	0	0	0	0	0	0	0
	0	0	0	0	0	0	0	0

Relocatable Student Stations

Number of students that will be educated in relocatable units, by school, in the current year, and the projected number of students for each of the years in the workplan.

Site	2012 - 2013	2013 - 2014	2014 - 2015	2015 - 2016	2016 - 2017	5 Year Average
WEWAHITCHKA ELEMENTARY	25	18	18	0	0	12
PORT SAINT JOE ELEMENTARY	0	0	0	0	0	0
PORT SAINT JOE JUNIOR SENIOR HIGH	0	126	126	0	0	50
HIGHLAND VIEW ELEMENTARY	0	0	0	0	0	0
WEWAHITCHKA JUNIOR SENIOR HIGH	0	158	158	0	0	63
GULF ADULT SCHOOL	0	0	0	0	0	0

Totals for GULF COUNTY SCHOOL DISTRICT						
Total students in relocatables by year.	25	302	302	0	0	126
Total number of COFTE students projected by year.	1,822	1,842	1,860	1,867	1,869	1,852
Percent in relocatables by year.	1 %	16 %	16 %	0 %	0 %	7 %

Leased Facilities Tracking

Existing leased facilities and plans for the acquisition of leased facilities, including the number of classrooms and student stations, as reported in the educational plant survey, that are planned in that location at the end of the five year workplan.

Location	# of Leased Classrooms 2012-2013	FISH Student Stations	Owner	# of Leased Classrooms 2016-2017	FISH Student Stations
WEWAHITCHKA ELEMENTARY	1	25		0	0
PORT SAINT JOE ELEMENTARY	0	0		0	0
PORT SAINT JOE JUNIOR SENIOR HIGH	0	0		0	0
HIGHLAND VIEW ELEMENTARY	0	0		0	0
WEWAHITCHKA JUNIOR SENIOR HIGH	0	0		0	0

GULF ADULT SCHOOL	0	0		0	0
	1	25		0	0

Failed Standard Relocatable Tracking

Relocatable units currently reported by school, from FISH, and the number of relocatable units identified as 'Failed Standards'.

Nothing reported for this section.

Planning

Class Size Reduction Planning

Plans approved by the school board that reduce the need for permanent student stations such as acceptable school capacity levels, redistricting, busing, year-round schools, charter schools, magnet schools, public-private partnerships, multitrack scheduling, grade level organization, block scheduling, or other alternatives.

Other than hiring new teachers there is space available to meet the requirements for class size reduction. There could possibly be a need for three new classrooms at Port St. Joe Elementary School. However, projected COFTE numbers are predicted to drop in the next five years reducing the need for new classrooms.

School Closure Planning

Plans for the closure of any school, including plans for disposition of the facility or usage of facility space, and anticipated revenues.

No schools will be closed in Gulf County

Five Year Survey - Ten Year Capacity

GULF COUNTY SCHOOL DISTRICT

10/8/2012

Schedule of capital outlay projects projected to ensure the availability of satisfactory student stations for the projected student enrollment in K - 12 programs for the future 5 years beyond the 5-year district facilities work program.

No items meet the criteria.

Five Year Survey - Ten Year Infrastructure

GULF COUNTY SCHOOL DISTRICT

10/8/2012

Proposed Location of Planned New, Remodeled, or New Additions to Facilities in 6 thru 10 out years (Section 28).

No items meet the criteria.

Plans for closure of any school, including plans for disposition of the facility or usage of facility space, and anticipated revenues in the 6 thru 10 out years (Section 29).

No items meet the criteria.

Five Year Survey - Ten Year Maintenance

GULF COUNTY SCHOOL DISTRICT

10/8/2012

District projects and locations regarding the projected need for major renovation, repair, and maintenance projects within the district in years 6 - 10 beyond the projects plans detailed in the five years covered by the work plan.

No items match the criteria.

Five Year Survey - Ten Year Utilization

GULF COUNTY SCHOOL DISTRICT

10/8/2012

Schedule of planned capital outlay projects identifying the standard grade groupings, capacities, and planned utilization rates of future educational facilities of the district for both permanent and relocatable facilities.

Grade Level Projections	FISH Student Stations	Actual FISH Capacity	Actual COFTE	Actual Utilization	Actual new Student Capacity to be added/removed	Projected COFTE	Projected Utilization
Elementary - District Totals	1,327	1,327	870.60	65.61 %	0	0	0.00 %
Middle - District Totals	0	0	0.00	0.00 %	0	0	0.00 %
High - District Totals	1,918	1,726	1,121.46	64.97 %	0	0	0.00 %
Other - ESE, etc	140	183	5.50	3.01 %	0	0	0.00 %
	3,385	3,236	1,997.56	61.73 %	0	0	0.00 %

Combination schools are included with the middle schools for student stations, capacity, COFTE and utilization purposes because these facilities all have a 90% utilization factor. Use this space to explain or define the grade groupings for combination schools.

No comments to report.

Five Year Survey - Twenty Year Capacity

GULF COUNTY SCHOOL DISTRICT

10/8/2012

Schedule of capital outlay projects projected to ensure the availability of satisfactory student stations for the projected student enrollment in K - 12 programs for the future 11 - 20 years beyond the 5-year district facilities work program.

No items match the criteria.

Five Year Survey - Twenty Year Infrastructure

GULF COUNTY SCHOOL DISTRICT

10/8/2012

Proposed Location of Planned New, Remodeled, or New Additions to Facilities in the 11 through 20 out years (Section 28).

No items meet the criteria.

Plans for closure of any school, including plans for disposition of the facility or usage of facility space, and anticipated revenues in the 11 through 20 out years (Section 29).

No items meet the criteria.

Five Year Survey - Twenty Year Maintenance

GULF COUNTY SCHOOL DISTRICT

10/8/2012

District projects and locations regarding the projected need for major renovation, repair, and maintenance projects within the district in years 11 - 20 beyond the projects plans detailed in the five years covered by the work plan.

No items match the criteria.

Five Year Survey - Twenty Year Utilization

GULF COUNTY SCHOOL DISTRICT

10/8/2012

Schedule of planned capital outlay projects identifying the standard grade groupings, capacities, and planned utilization rates of future educational facilities of the district for both permanent and relocatable facilities.

Grade Level Projections	FISH Student Stations	Actual FISH Capacity	Actual COFTE	Actual Utilization	Actual new Student Capacity to be added/removed	Projected COFTE	Projected Utilization
Elementary - District Totals	1,327	1,327	870.60	65.61 %	0	0	0.00 %
Middle - District Totals	0	0	0.00	0.00 %	0	0	0.00 %
High - District Totals	1,918	1,726	1,121.46	64.97 %	0	0	0.00 %
Other - ESE, etc	140	183	5.50	3.01 %	0	0	0.00 %
	3,385	3,236	1,997.56	61.73 %	0	0	0.00 %

Combination schools are included with the middle schools for student stations, capacity, COFTE and utilization purposes because these facilities all have a 90% utilization factor. Use this space to explain or define the grade groupings for combination schools.

No comments to report.

STATE OF FLORIDA

COUNTY OF GULF

GRANT OF EASEMENT

THIS INDENTURE made and entered into on this _____ day of October, 2012, by and between **GEORGE W. DUREN FAMILY LIMITED PARTNERSHIP**, hereinafter referred to as "Grantor," and the **CITY OF PORT ST. JOE, a Florida municipal corporation**, its successors and assigns, hereinafter referred to as "Grantee,"

WITNESSETH:

WHEREAS, Grantee desires to obtain an easement over and under a portion of Grantor's property described in Exhibit "A", to construct, install and maintain underground utilities, and

WHEREAS, The Easement Property is located in the northwest corner of the property described in Exhibit A and is more particularly described in the drawing attached hereto as Exhibit B, and

WHEREAS, Grantor has agreed to grant Grantee an easement over and under a portion of its property for the aforesaid purposes on the terms and conditions set forth below, and

WHEREAS, Grantor desires a license to use certain property of Grantee locate immediately west of the property described in Exhibit "A" ("License Property"),

NOW, THEREFORE Grantor, for and in consideration of Ten and no/100 Dollars (\$10.00) and other good and valuable considerations, the receipt of which is hereby acknowledged, does hereby grant unto Grantee a non-exclusive easement over and under the Easement Property for the purpose of constructing, installing and maintaining underground utilities, and Grantee grants to Grantor a license to use the License Property of Grantee.

This non-exclusive easement and license is granted on the following specific terms and conditions, to-wit:

1. Upon completing construction of the underground utilities, Grantee shall restore the surface of the Easement Parcel to its condition prior to installation of the underground utilities.
2. Grantee shall have the right to come on the Easement Property at any time for the purpose of maintaining the underground utilities. Any time that Grantee digs on or disturbs the surface of the Easement Parcel, Grantee agrees to restore the surface of the Easement Property to its prior condition.
3. All construction costs incurred in completing the underground utilities shall be paid by Grantee upon completion of the work in order to prevent the imposition of any labor or material liens.
4. Grantee shall hold Grantor harmless for any liability arising out of the actions of Grantee with respect to the Easement Property.

5. The License Property is a strip of land immediately west of the Exhibit "A" property and is bounded on the west by a City stormwater pond chain link fence. Grantor may use the License Property for purposes in connection with its business operation so long as Grantee has unfettered access to the fence. Grantor shall make no permanent improvements on the License Property.

6. Grantor shall hold Grantee harmless for any liability arising out of the actions of Grantor with respect to the License Property.

IN WITNESS WHEREOF, the parties hereto have executed these presents to be effective as of the day and year first above written.

Signed, sealed and delivered in
the presence of:

GEORGE W. DUREN FAMILY LIMITED
PARTNERSHIP

By _____
George W. Duren, General Partner

Witness Signature
Printed Name: _____

Witness Signature
Printed Name: _____

**STATE OF FLORIDA
COUNTY OF GULF**

The foregoing instrument was acknowledged before me this ____ day of October, 2012, by George W. Duren, General Partner of George W. Duren Family Limited Partnership, who is [] personally known to me or [] who produced _____ as identification.

Notary Public State of Florida
My commission expires: _____

Signed, sealed and delivered in
the presence of:

CITY OF PORT ST. JOE, a Florida
municipal corporation

Witness Signature

Printed Name:_____

By_____

Mel C. Magidson, Mayor

ATTEST:

Witness Signature

Printed Name:_____

Charlotte M. Pierce, City Clerk

STATE OF FLORIDA
COUNTY OF GULF

The foregoing instrument was acknowledged before me this ____ day of October, 2012, by Mel C. Magidson, Mayor and Charlotte M. Pierce, City Clerk, of the City of Port St. Joe, a Florida municipal corporation, who is/are [] personally known to me or [] who produced _____ as identification.

Notary Public State of Florida

My commission expires:_____

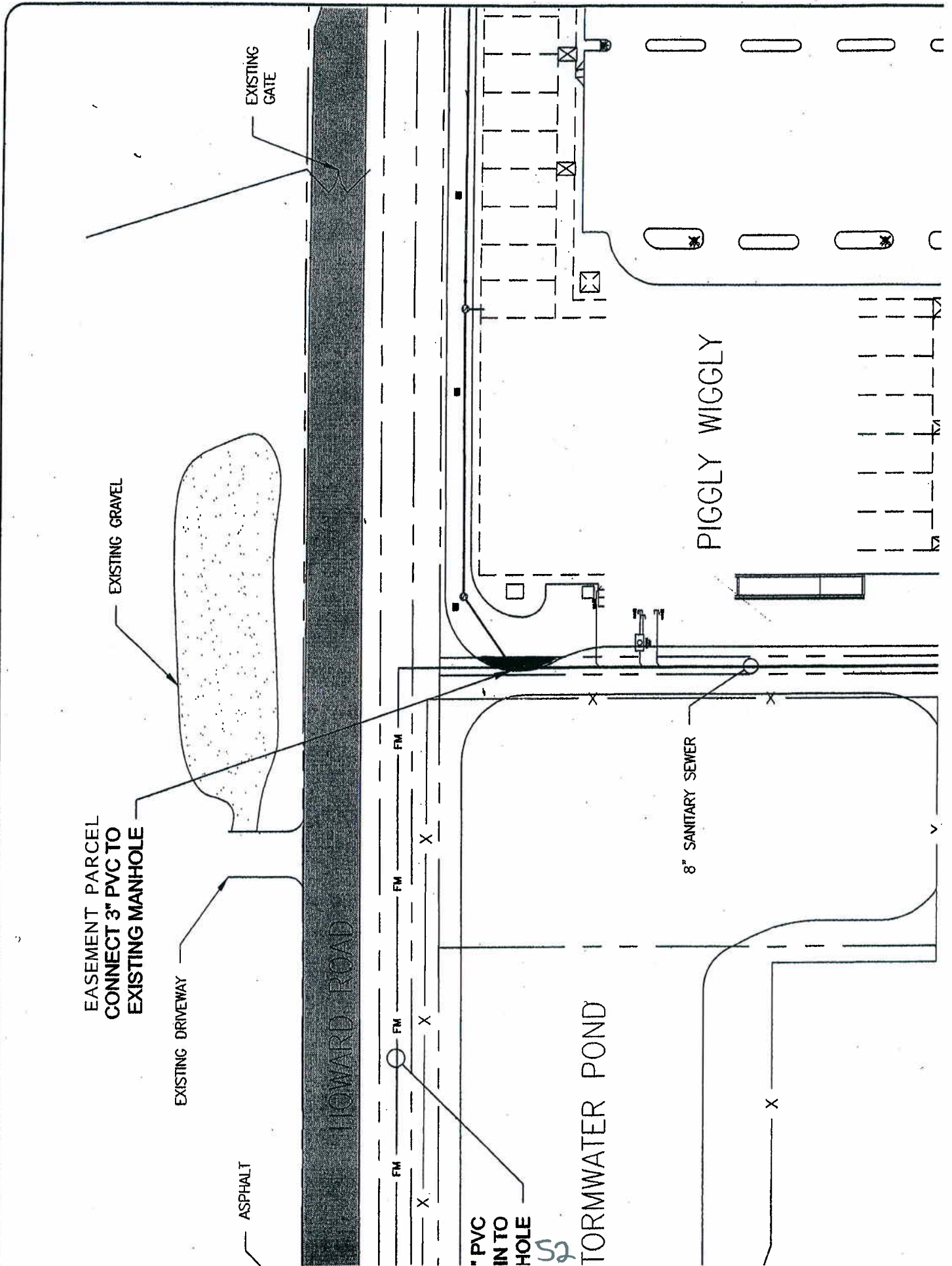

Exhibit A

Parcel ID#:04596-050R

A parcel of land lying in Section 2, Township 8 South, Range 11 West, Gulf County, Florida; being more particularly described as follows:

Begin at the 4"x 4" concrete monument at the intersection of the West right of way line of US Highway 98 and the North right of way line of 1st Street; thence along the North right of way of 1st Street S 89°55'54" W, 809.07 feet to an iron rod and cap; thence N 00°04'08" W, 356.68 feet to an iron rod and cap; thence N 89°54'57" E, 685.00 feet to a 4"x 4" concrete monument on the West right of way line of US Highway 98; thence along the West right of way line of US Highway 98, S 19°14'19" E, 377.82 feet to the point of beginning.

Together with;

Parcel ID#04596-055R

A parcel of land lying in Section 2, Township 8 South, Range 11 West, Gulf County, Florida; being more particularly described as follows:

Commence at the 4"x 4" concrete monument at the intersection of the West right of way line of US Highway 98 and the North right of way line of 1st Street; thence along the North right of way of 1st Street S 89°55'54" W, 809.07 feet to the point of beginning thence continue along said North right of way line, S 89°55'54" W, 12.00 feet, thence N 00°04'08" W, 356.67 feet; thence N 89°54'57" E, 12.00 feet, thence S 00°04'06" E, 356.68 feet to the Point of Beginning.

*Port St Joe Garden Club
216 8th Street
Port St Joe, Florida 32456*



Oct 27, 2012

Mr. Jim Anderson
City Manager
P.O. Box 278
Port St Joe, FL 32456

Dear Mr. Anderson,

The Port St Joe Garden Club would like to use the Centennial Building to host the Florida Garden Club's District II meeting on May 16, 2013. Approximately one hundred garden club members from the surrounding counties will attend. We will need the building from noon May 15, 2013, to decorate, and the entire day of May 16, 2016. Any consideration in the cost of this rental would be appreciated, for we are a small local non-profit group who work for the good of our community.

I can be reached at 273 Conway Drive, Port St Joe, or bconway@fairpoint.net. My phone number is 850-648-5675. Thank you for your time and deliberation.

Sincerely,

Barbara Conway
President

cc. Mr. Tan Smiley

LEASE AGREEMENT

The City of [Port St. Joe](#), Florida (hereinafter "Lessor") hereby leases to [St. Joseph Historical Society, Inc.](#), a Florida not for profit corporation (hereinafter "Lessee") the Property (Property) in [Port St. Joe](#), [Gulf County](#), Florida, more specifically described in Exhibit "A" attached hereto and incorporated herein.

This conveyance is subject to easements, restrictions, limitations and conditions of record if any now exist, but any such interests that may have been terminated are not hereby reimposed.

1. Term of Lease: This lease agreement shall have an initial term of [one \(1\) year](#), commencing [December 1, 2012](#), and expiring [December 1, 2013](#). The term of lease may be extended for a second term of five (5) years unless written notice is given by either the Lessee or Lessor of its intent not to renew the lease. Said notice must be mailed certified mail, return receipt requested, at lease thirty (30) days [in advance](#).
2. Restrictions on the Use of Property: Lessee shall make the building available to the general public for either environmental or historical education or traditional recreational and park activities, including small community meetings, and such other activities as the Lessor may from time to time determine will enhance the quality of life for citizens and visitors in a manner that reflects the principles of good stewardship and for all lawful purposes related thereto. Staff who primarily work to support public access and park management to site facilities may have office space at Florida Communities Trust (FCT) sites. The number of lessee staff and the total area utilized for lessee office use should be minimized and may not exceed fifty percent of the building to maximize public use of said facility.
3. Expenses. All expenses attributable to the use of the property shall be borne exclusively by the Lessee, including but not limited to utilities. [The City of Port St. Joe is responsible for City water, sewer and garbage and the St. Joseph Historical Society, Inc., is responsible for all other utilities.](#)
4. Insurance. The Lessor shall be included as an insured or additional insured on any insurance obtained by the Lessee on the premises and any liability insurance acquired by Lessee in the course of conducting the business of the lessee on the leased property. Lessee shall carry such limits of fire and casualty insurance as are recommended by Lessee's insurance agent and public liability insurance of at least [\\$1,000,000.00](#).

5. FCT Requirements. Lessee acknowledges that Lessor has acquired title to the leased properties through a grant from the FCT and that Lessee has been informed of all requirements and conditions imposed on the Lessor in connection with such grant. The Property is subject to certain limitations provided in the FCT approved Management Plan and Declaration of Restrictive Covenants a/k/a Grant Award Agreement (Declaration). The Declaration is recorded at Official Records Book [186](#) Page [986](#) in the [Gulf](#) County public records and the terms of the Declaration are superior to any other restrictions that may be placed upon the property. The terms of the Management Plan and the Declaration are hereby incorporated by reference. All activities by Lessee and Lessor shall be consistent with the Declaration. FCT shall approve all leases, easements or other similar documents that affect the property. Lessee covenants and agrees that it will comply with all such requirements and conditions in its use of the leased property. Lessee covenants and agrees to comply with and fulfill all obligations and requirements imposed on the Lessor by the terms of the approved Management Plan dated ----, 20-- which consists of pages numbered 1 through -- is attached hereto (Exhibit "B").

6. Duties. Lessor and Lessee are responsible for the specific actions or activities outlined in the Lessor / Lessee Responsibilities document that is attached as Exhibit "C" and herein incorporated by reference. The Lessor - / Lessee Responsibilities document may be amended in writing upon mutual agreement by all parties.

7. Grants. The Lessor agrees to apply for grants which may be available to it from time to time to fund improvements to the property or funds to conduct the not for profit functions of the Lessee. The responsibility and expense preparing grant applications shall be borne exclusively by the Lessee.

8. Termination of Lease: If at any time during the term of this lease the Lessor is required to pay any expense attributable to the leased property or the Lessee fails to pay such expenses the Lessor shall have the right to automatically terminate this lease agreement and Lessee shall immediately vacate the premises.

9. Notice. Any notice given to the Lessor shall be mailed certified mail, return receipt requested, to City of [Port St. Joe](#), Attn: City [Manager](#), [P. O. Box 278](#), [Port St. Joe](#), Florida [32457](#). Any notice given to Lessee shall be mailed certified mail, return receipt requested, to [St. Joseph Historical Society, Inc.](#), [P. O. Box 231](#), [Port St. Joe](#), FL [32457](#). Notice given to FCT shall be mailed certified mail, return receipt requested to Department of Environmental Protection, Florida Communities Trust, 3800 Commonwealth Blvd. MS#115, Tallahassee, Florida 32399.

Dated this _____ day of _____, 2012.

LESSOR

CITY COMMISSION OF THE
CITY OF PORT ST. JOE, FL

ATTEST:

_____, Mayor
Mel C. Magidson, Jr.,

_____, City Clerk
Charlotte M. Pierce
(SEAL)

LESSEE

ST. JOSEPH HISTORICAL SOCIETY, INC.

ATTEST:

_____, Vice President
Lynda N. Bordelon

_____, Secretary
Linda M. Wood
(SEAL)

Reviewed and Approved by
Florida Communities Trust:

Al Dougherty, Deputy Secretary
Land and Recreation

Port St Joe Fire Department

To: Jim Anderson City Manger

From: John Ford Fire Chief

Reference: MSA

Dear Sir,

The fire department has five used MSA air packs. These units were replaced last year due to unable to get parts and not being able to certify them for fire fighting. We would like permission to take and depose of these units. They hold no value and it is not recommended to give these units to other fire department due to liability reasons.

Serial numbers,

1. NH280247
2. NH280243
3. NH280501
4. NL281152
5. NL284017

Thank you,

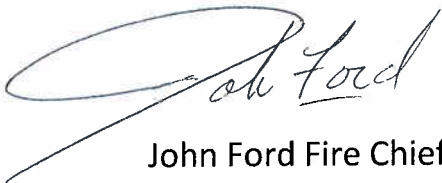
A handwritten signature in blue ink, appearing to read "John Ford", with a large, sweeping initial "J".

John Ford Fire Chief



November 12, 2012

Port St Joe
John Grantland
2013 Ford F-150 2WD Reg Cab 126" XL (F1C)

OPTION CODE	Item	Total
F1C	Base Vehicle	\$15,214.00
99M	3.7L FFV V-6 Gas Engine	STD
446	6 Speed Automatic Transmission	STD
96W	Spray In Liner	\$475.00
	Delivery	\$125.00
YZ	Exterior Color: Oxford White	
AS	Interior Color: Flint	
TOTAL		\$15,814.00

If you have any questions or need any additional information please to contact me anytime.

Sincerely Yours,

Richard Weissinger

Commercial Fleet Sales

Bartow Ford Company

2800 US Hwy 98 North

Bartow, FL 33030

Direct Line (813) 477-0052

Fax (863) 533-8485

59

2800 US Hwy North
Bartow, Florida 33830

Change Order

No. 5

Date of Issuance: _____ Effective Date: _____

Project: Wastewater Treatment Facility Improvements	Owner: City of Port St. Joe	Owner's Contract No.:
Contract:		Date of Contract:
Contractor: North Florida Construction, Inc., P.O. Box 129, Clarksville, FL 32430		Engineer's Project No.: 019.093

The Contract Documents are modified as follows upon execution of this Change Order:

Description: Time extension due to delay of permanent power installation.

Decrease in the Contract amount for the unused owner's contingency and finalizing / closing purchase orders.

Attachments: (List documents supporting change):

CHANGE IN CONTRACT PRICE:

Original Contract Price:

\$ 8,661,848.00

Decrease from previously approved Change Orders

No. 1 to No. 4:

\$ 3,824,729.52

Contract Price prior to this Change Order:

\$ 4,837,118.48

Decrease to this Change Order:

\$ 338,980.30

Contract Price incorporating this Change Order:

\$ 4,498,138.18

CHANGE IN CONTRACT TIMES:

Original Contract Times: ☐ Working days ☒ Calendar days

Substantial completion (date): 20 JUNE 2012

Ready for final payment (date): 20 JULY 2012

Increase from previously approved Change Orders

No. 1 to No. 4:

Substantial completion (days): 30 DAYS

Ready for final payment (days): 45 DAYS

Contract Times prior to this Change Order:

Substantial completion (date): 20 JULY 2012

Ready for final payment (date): 31 AUGUST 2012

Increase of this Change Order:

Substantial completion (date): 25 JULY 2012

Ready for final payment (date): 05 SEPTEMBER 2012

Contract Times with all approved Change Orders:

Substantial completion (date): 25 JULY 2012

Ready for final payment (date): 05 SEPTEMBER 2012

RECOMMENDED:

By: _____
Engineer (Authorized Signature)

Date: _____

Approved by Funding Agency (if applicable): _____

ACCEPTED:

By: _____
Owner (Authorized Signature)

Date: _____

ACCEPTED:

By: _____
Contractor (Authorized Signature)

Date: _____

Date: _____

Change Order

Instructions

A. GENERAL INFORMATION

This document was developed to provide a uniform format for handling contract changes that affect Contract Price or Contract Times. Changes that have been initiated by a Work Change Directive must be incorporated into a subsequent Change Order if they affect Price or Times.

Changes that affect Contract Price or Contract Times should be promptly covered by a Change Order. The practice of accumulating Change Orders to reduce the administrative burden may lead to unnecessary disputes.

If Milestones have been listed in the Agreement, any effect of a Change Order thereon should be addressed.

For supplemental instructions and minor changes not involving a change in the Contract Price or Contract Times, a Field Order should be used.

B. COMPLETING THE CHANGE ORDER FORM

Engineer normally initiates the form, including a description of the changes involved and attachments based upon documents and proposals submitted by Contractor, or requests from Owner, or both.

Once Engineer has completed and signed the form, all copies should be sent to Owner or Contractor for approval, depending on whether the Change Order is a true order to the Contractor or the formalization of a negotiated agreement for a previously performed change. After approval by one contracting party, all copies should be sent to the other party for approval. Engineer should make distribution of executed copies after approval by both parties.

If a change only applies to price or to times, cross out the part of the tabulation that does not apply.

Richard Burkett
Code Enforcement Insepector

**Code Enforcement
2012 Activity**

Activity As of 11-13-12
City Of Port St. Joe

	Open	Closed	Total	Increase Since 10/24/12
Unlawful Accumulation	21	154	175	9
Substandard Structure	6	2	8	2
Abandoned Vechicle	3	8	11	
Unlawful Sewer	0	3	3	
Land regulation Violation	0	4	4	
Business Lic. Violation	0	2	2	
Special Master Hearings		2	2	
Building Demolition	0	4	4	
Waste Violation	4	131	135	16
Sign Violation	1	484	485	66

Total	35	Total	794	Total	829	Total	93
				2012 Year Cases			

**Code Enforcement
2012 Activity**

Activity As of 10-24-12
City Of Port St. Joe

	Open	Closed	Total	Increase Since 10/11/12
Unlawful Accumulation	17	149	166	6
Substandard Structure	4	2	6	2
Abandoned Vechicle	5	6	11	3
Unlawful Sewer	0	3	3	
Land regulation Violation	1	3	4	1
Business Lic. Violation	0	2	2	
Special Master Hearings		2	2	
Building Demolition	0	4	4	
Waste Violation	5	113	118	10
Sign Violation	0	420	420	

Total	32	Total	704	Total	736	Total	22
				2012 Year Cases			