

**January 30, 2024  
Workshop Meeting  
5:00 P.M.**



## City of Port St. Joe

Rex Buzzett, Mayor-Commissioner  
Eric Langston, Commissioner, Group I  
Steve Kerigan, Commissioner, Group II  
Brett Lowry, Commissioner, Group III  
Scott Hoffman, Commissioner, Group IV

[All persons are invited to attend these meetings. Any person who decides to appeal any decision made by the Commission with respect to any matter considered at said meeting will need a record of the proceedings, and for such purpose may need to ensure that a verbatim record of the proceedings is made, which record includes the testimony and evidence upon which the appeal is to be based. The Board of City Commission of the City of Port St. Joe, Florida will not provide a verbatim record of this meeting.]

# **BOARD OF CITY COMMISSION**

**Workshop Public Meeting**

**5:00 P.M.**

**Tuesday January 30, 2024**

## **Call to Order**

- **10<sup>th</sup> Street Sports Complex Conceptual Plan**

**Citizens to be Heard**

**Discussion Items by Commissioners**

**Motion to Adjourn**

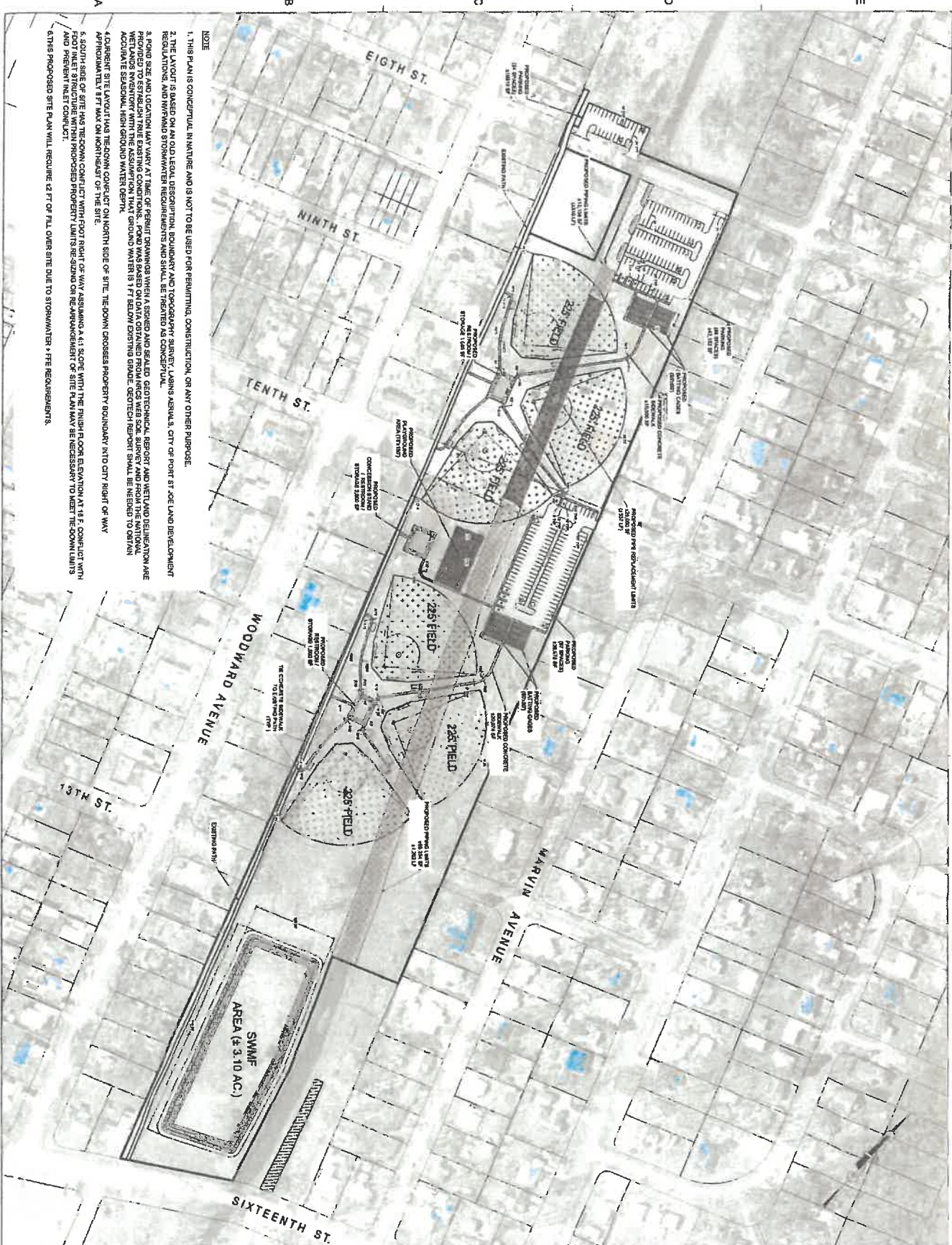

- NOTE**
1. THIS PLAN IS CONCEPTUAL IN NATURE AND IS NOT TO BE USED FOR PERMITTING, CONSTRUCTION, OR ANY OTHER PURPOSE.
  2. THE LAYOUT IS BASED ON AN OLD LATERAL DESCRIPTION, BOUNDARY AND TOPOGRAPHY SURVEY, LAYING AREA, & CITY OF PORT ST. JOE LAND DEVELOPMENT REGULATIONS, AND WYOMING STORMWATER REQUIREMENTS AND SHALL BE TREATED AS CONCEPTUAL.
  3. FOUND SIZE AND LOCATION MAY VARY AT TIME OF PERMIT DRAWINGS WHEN A SIGNED AND SEALED GEOTECHNICAL REPORT AND METHOD OF DETAILING ARE PROVIDED TO ESTABLISH THE EXISTING CONDITIONS. FOUNDS WERE BASED ON DATA OBTAINED FROM WGS 84 SURVEY AND FROM THE NATIONAL ACCURATE SPATIAL HIGH GROUND WATER DATA SET (1 FT BELOW EXISTING GROUND). GEOTECH REPORT SHALL BE NEEDED TO OBTAIN ACCURATE SPATIAL HIGH GROUND WATER DATA.
  4. ADJACENT SITE LAYOUT HAS THEORETICAL CONTACT ON NORTH SIDE OF SITE. THE DOWN CROSS PROPERTY BOUNDARY INTO CITY RIGHT OF WAY APPROXIMATELY 177' WAS ON THE BASIS OF THE SITE.
  5. SOUTH SIDE OF SITE HAS THE DOWN CONFLICT WITH FRONT RIGHT OF WAY ASSUMING A 4:1 SLOPE WITH THE FINISH FLOOR ELEVATION AT 18' F. CONFLICT WITH ADJACENT INLET CONFLICT.
  6. THIS PROPOSED SITE PLAN WILL REQUIRE 12 FT OF FILL OVER SITE DUE TO STORMWATER + FFE REQUIREMENTS.

**PORT ST JOE  
10TH STREET  
SPORTS COMPLEX**

CITY OF PORT ST. JOE  
GULF COUNTY, FLORIDA

**Dewberry**

324 Market Drive  
Port St. Joe, FL 32468  
850.227.7200

DATE: 11/20/2018

PROJECT: 10TH STREET SPORTS COMPLEX - MASTER PLAN (HIGHLIGHTS) - PRELIMINARY - BALTIMORE, MD. CD BY: GDM/MS

SHEET NO. **P1**

**REVISIONS**

NO.	DESCRIPTION	DATE

DRAWN BY: K. GILKINS  
 APPROVED BY: A. LONER  
 CHECKED BY: C. STONER  
 DATE: DECEMBER 2023

**TITLE**  
 SITE PLAN

SCALE: 1" = 100'

0' 50' 100' 200'

FILE: PRIMARY DOCUMENTS  
 NOT FOR CONSTRUCTION

JOHNS & MARY, P.E. 8753  
 DE 000794